



# TECHNICAL SPECS 1995 RANGE

# TECHNICAL SPECS 1995 PRODUCT RANGE

**PRODUCT:** HEAD SET

**DATE:** SET - 1995

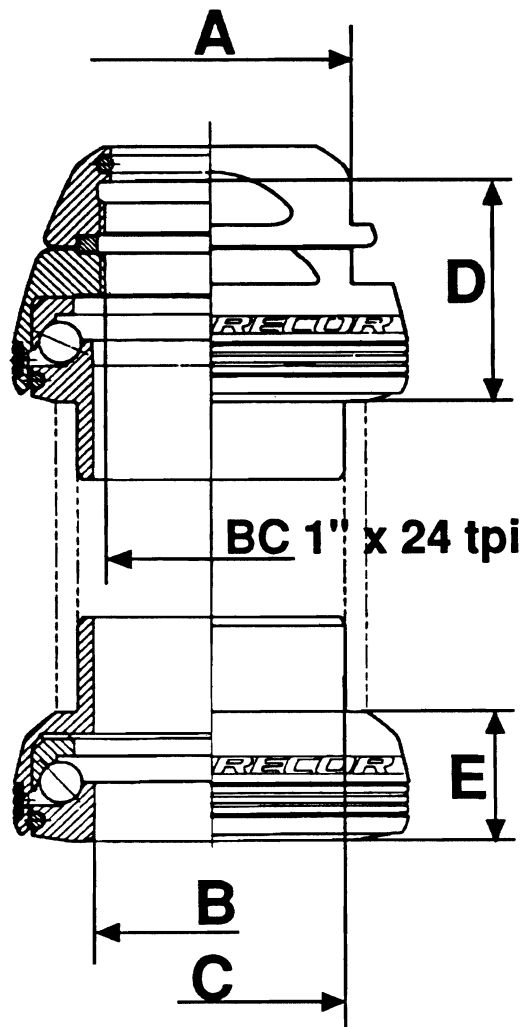

TYPE	A	B	C	D	E
RECORD - HS-11RE	32	26,4	30,2	26	15,1
CHORUS - HS-01CH	32	26,4	30,2	26	15,1
ATHENA - HS-11AT	32	26,4	30,2	26	15,6
VELOCE - HS-21VL	32	26,4	30,2	26	15,6
MIRAGE - HS-01MI	32	26,4	30,2	26	15,6

# TECHNICAL SPECS 1995 PRODUCT RANGE

**PRODUCT:** RECORD BOTTOM BRACKET

**DATE:** SET - 1995

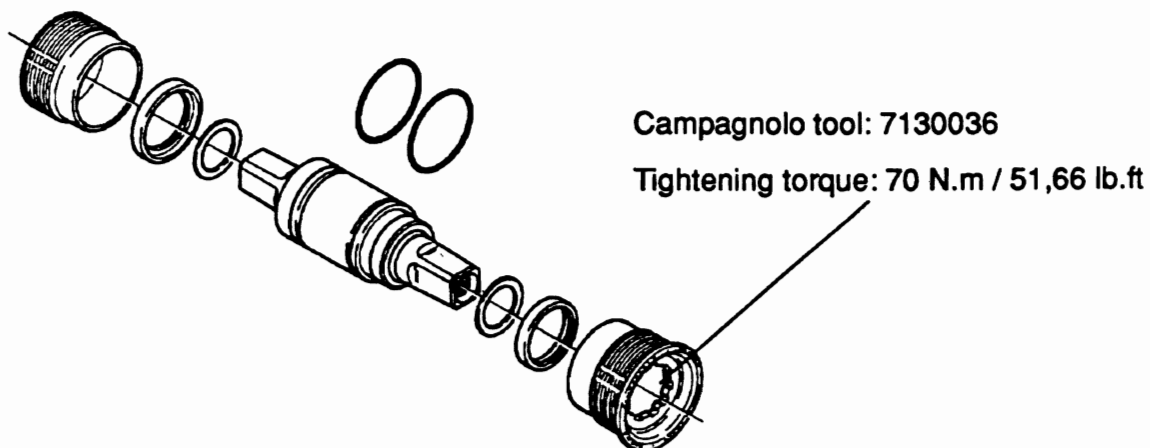

ITALIAN: 36 x 24tpi  
ENGLISH: 1,370 x 24TPI

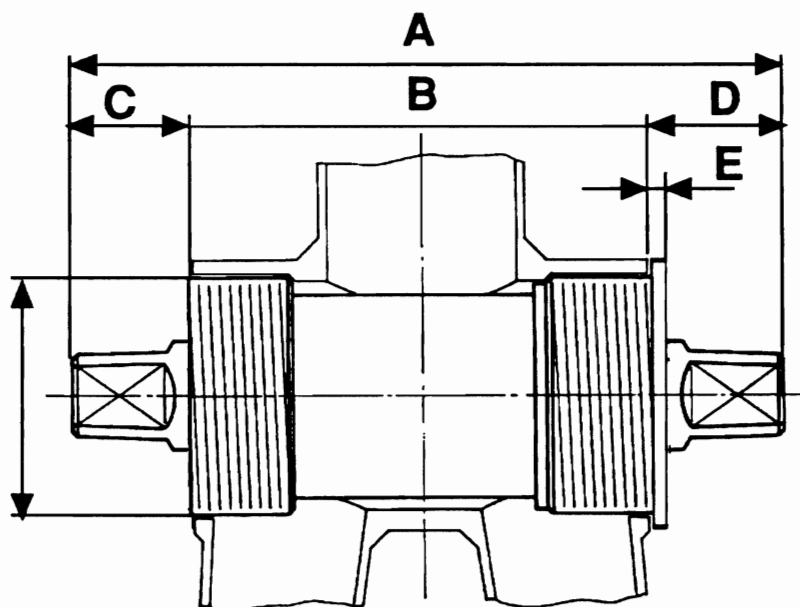

TYPE	A	B	C	D	E
BB-21RECART	102	70	16	16	2
BB-23RECART	102	68	17	17	2

# TECHNICAL SPECS 1995 PRODUCT RANGE

**PRODUCT:** ATHENA-RACING T BOTTOM BRACKET

**DATE:** SET - 1995

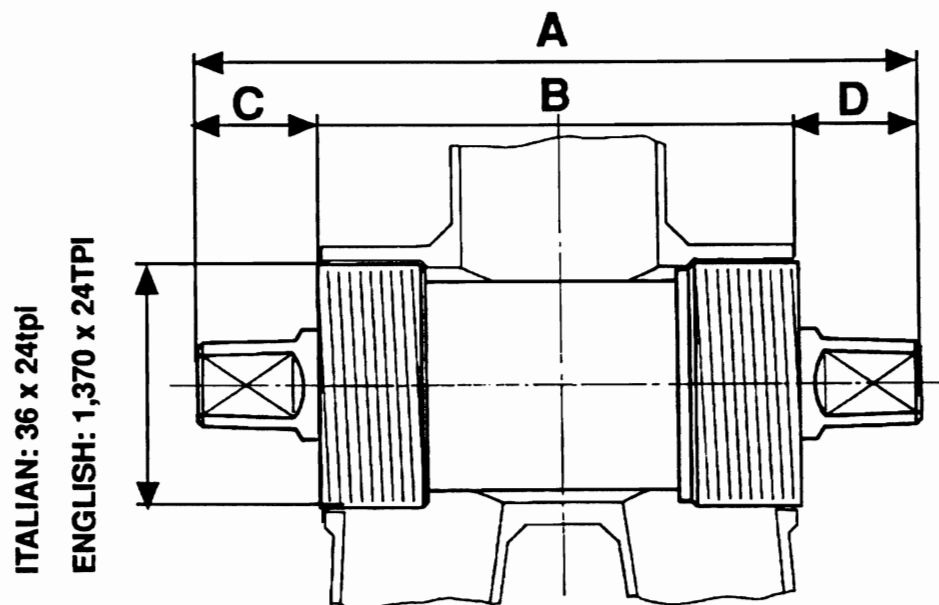
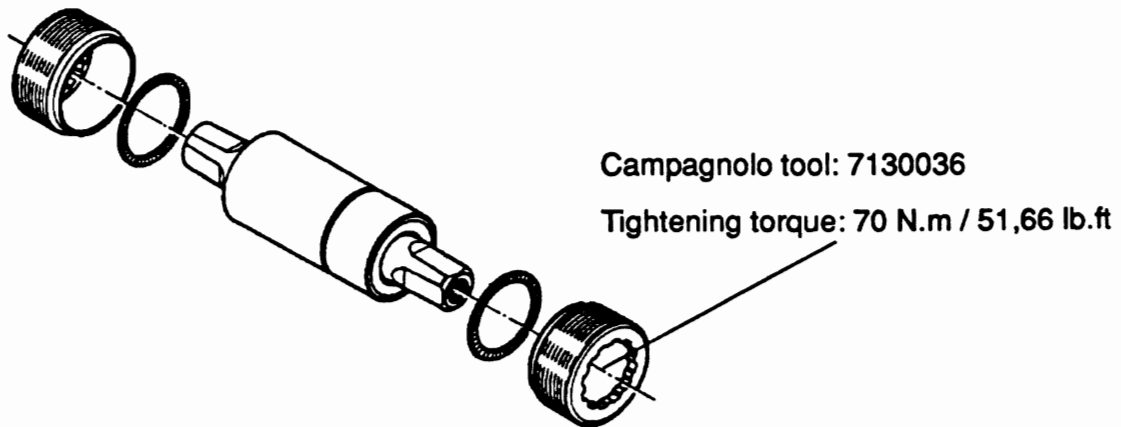

TYPE	A	B	C	D
ITALIAN - BB-01ATCART	111	70	20,5	20,5
ENGLISH - BB-03ATCART	111	68	21,5	21,5
ITALIAN - BB-01RA3	115,5	70	22,75	22,75
ENGLISH - BB-03RA3	115,5	68	23,75	23,75

# TECHNICAL SPECS 1995 PRODUCT RANGE

**PRODUCT:** VELOCE - MIRAGE BOTTOM BRACKET

**DATE:** SET - 1995

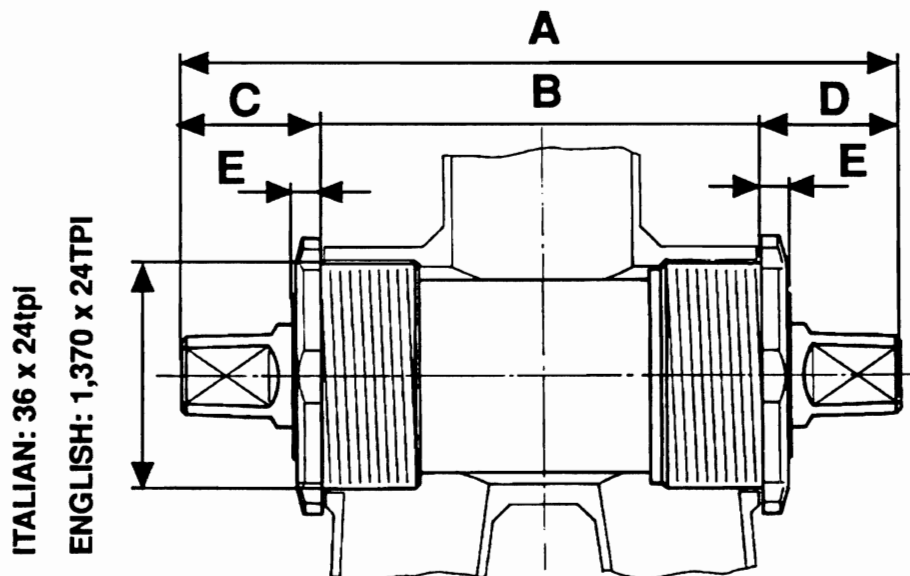
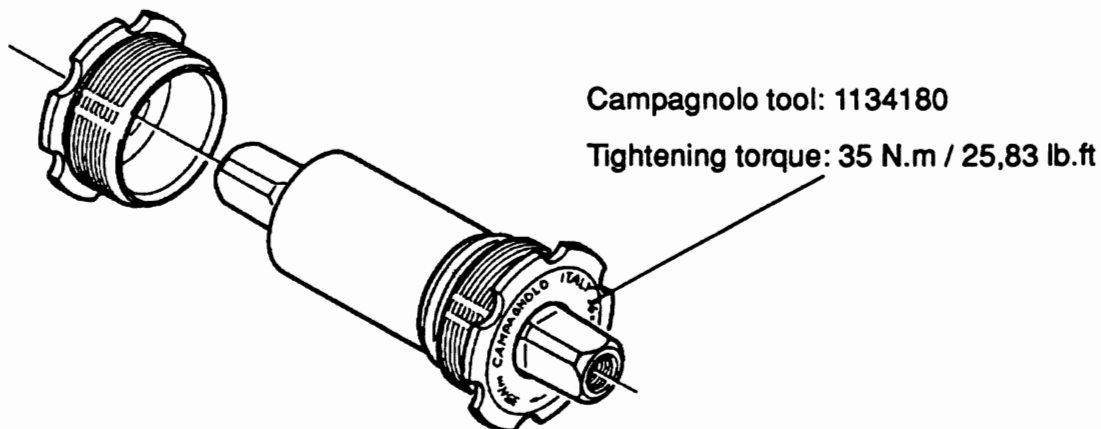

TYPE	A	B	C	D	E
VELOCE - BB-01VLCART	111	70	20,5	20,5	3,5
VELOCE - BB-03VLCART	111	68	21,5	21,5	3,5
MIRAGE - BB-01MICART	111	70	20,5	20,5	3
MIRAGE - BB-03MICART	111	68	21,5	21,5	3

# TECHNICAL SPECS 1995 PRODUCT RANGE

**PRODUCT:** CRANKSET

**DATE:** SET - 1995

Allen key 8 mm

Allen key 5 mm

Tightening torque:

Tightening torque: 6 N.m / 4,42 lb.ft

32+38 N.m / 23,6+28 lb.ft

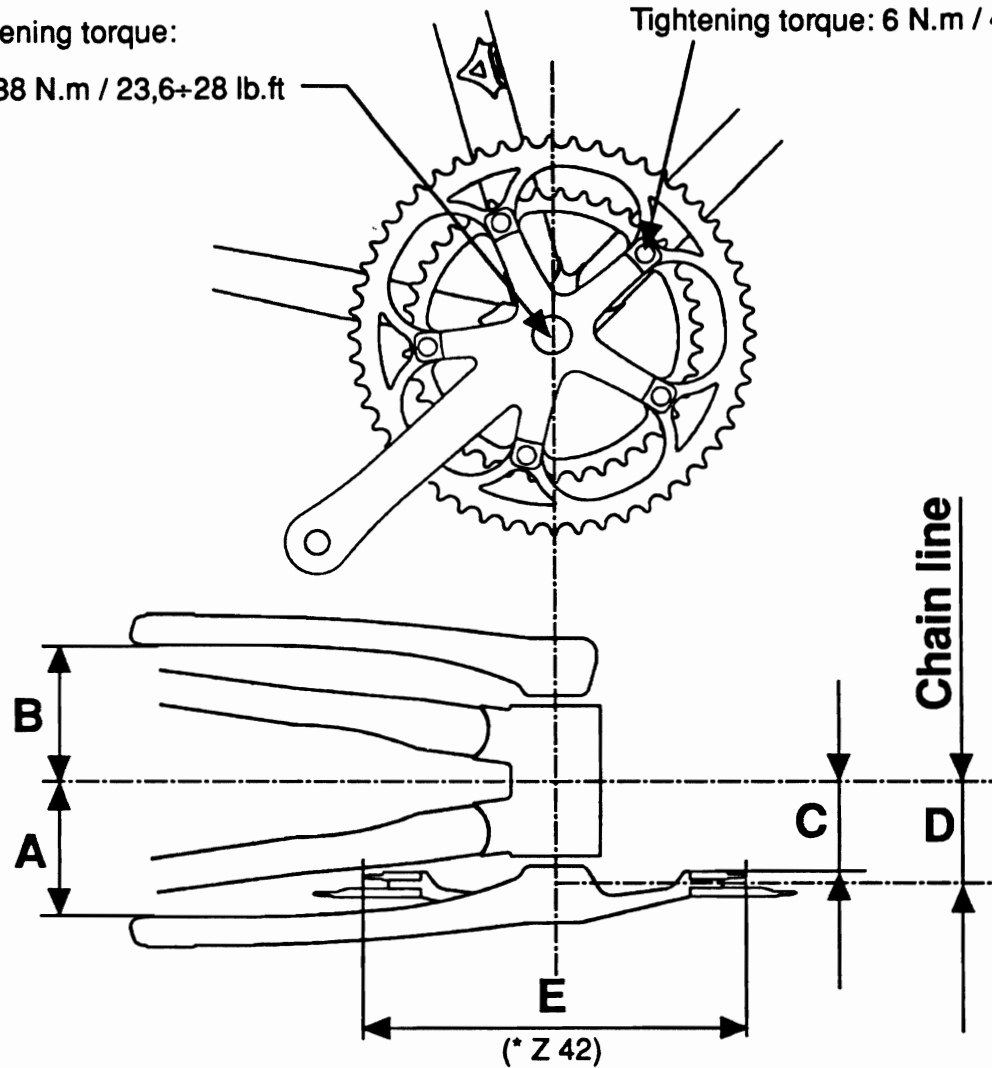

TYPE	A	B	C	D	E
RECORD - FC-21RE	59	59	37,5	43,5	174,2*
CHORUS - FC-21CH	59	59	37,5	43,5	174,2*
ATHENA - FC-21AT	59	59	37,5	43,5	174,2*
VELOCE - FC-11VL	59	59	37,5	43,5	174,2*
MIRAGE - FC-01MI	59	59	37,5	43,5	174,2*
AVANTI - FC-01AV	59	59	37,5	43,5	174,2*

# TECHNICAL SPECS 1995 PRODUCT RANGE

**PRODUCT:** TRIPLE CRANKSET

**DATE:** SET - 1995

Allen key 8 mm

Tightening torque:

32+38 N.m / 23,6+28 lb.ft

Allen key 5 mm

Tightening torque:

6 N.m / 4,42 lb.ft

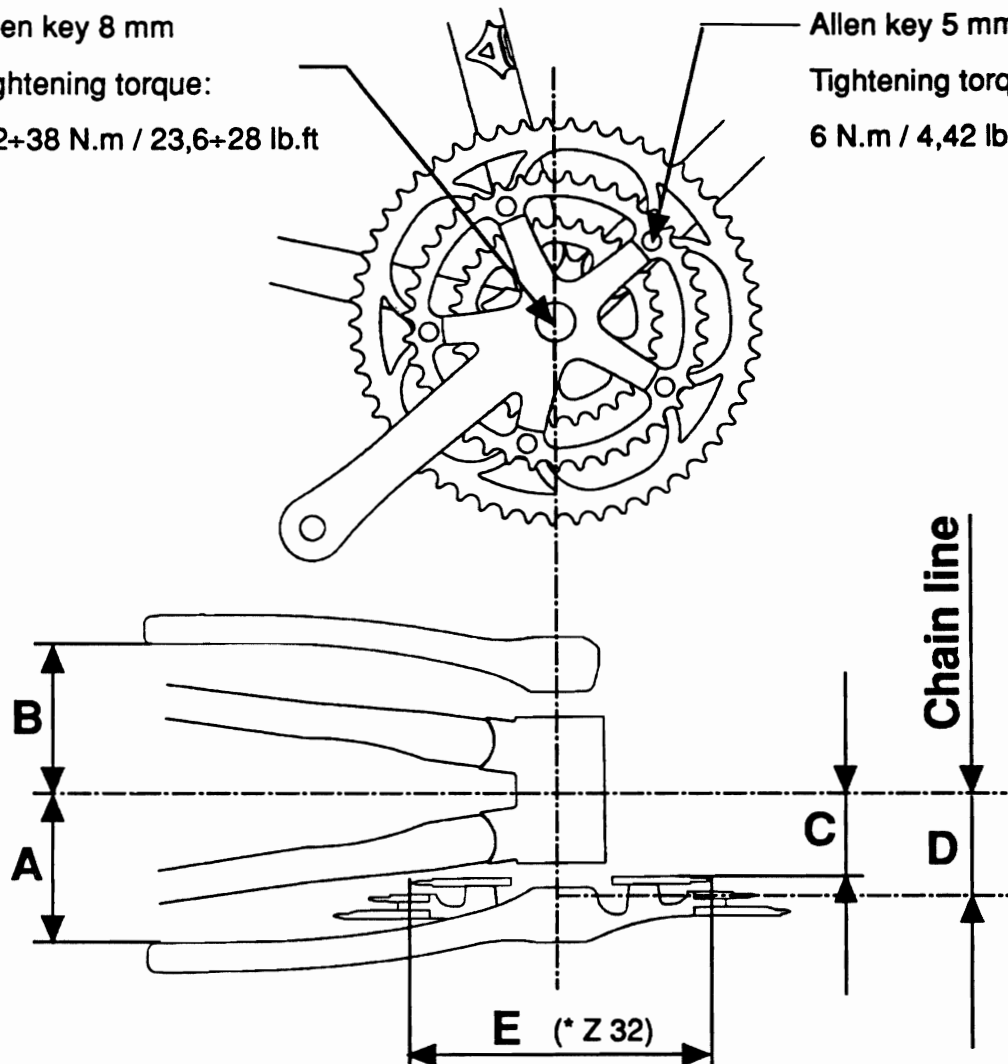

TYPE	A	B	C	D	E	AXLE 111mm
RACING T - FC-01RA3	65,5	59	35,5	45	134*	
VELOCE T - FC-01VL3	65,5	59	35,5	45	134*	
MIRAGE T - FC-01MI3	65,5	59	35,5	45	134*	

TYPE	A	B	C	D	E	AXLE 115,5mm
RACING T - FC-01RA3	67,75	61,25	37,75	47,25	134*	
VELOCE T - FC-01VL3	67,75	61,25	37,75	47,25	134*	
MIRAGE T - FC-01MI3	67,75	61,25	37,75	47,25	134*	

*Campagnolo*

*Campy  
bike  
2000*

# TECHNICAL SPECS 1995 PRODUCT RANGE

**PRODUCT:** FRONT DERAILLEUR BRAZE-ON

**DATE:** SET - 1995

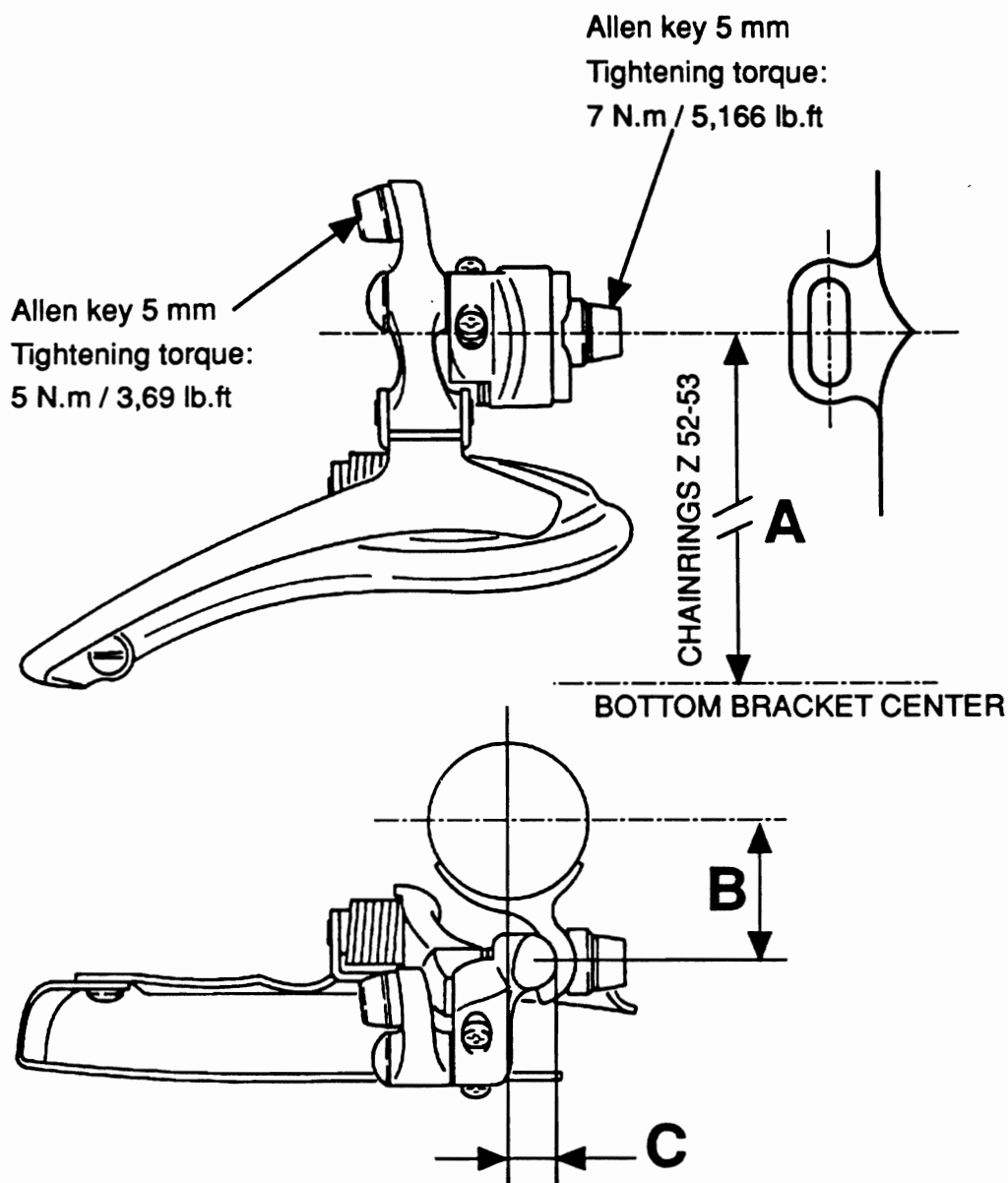

TYPE	A	B	C
RECORD - FD-21SRE	148	24,75	9,5
VELOCE - FD-21SVL	148	24,75	9,5
MIRAGE - FD-01SMI	148	24,75	9,5
AVANTI - FD-01SAV	148	24,75	9,5



# TECHNICAL SPECS 1995 PRODUCT RANGE

**PRODUCT:** FRONT DERAILLEUR CLIP-ON

**DATE:** SET - 1995

Allen key 5 mm  
Tightening torque:  
5 N.m / 3,69 lb.ft

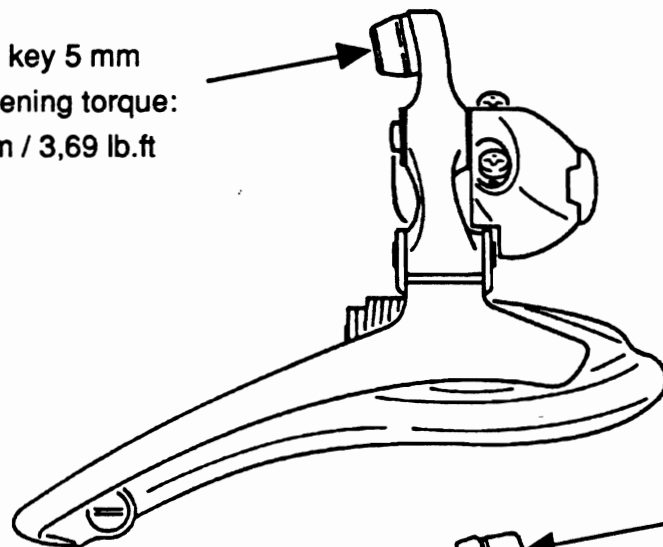

Allen key 5 mm  
Tightening torque:  
3,5 N.m / 2,58 lb.ft

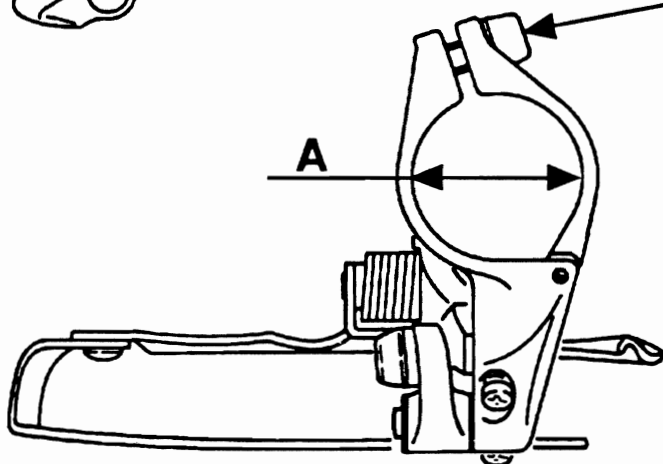

TYPE	A	Ø 28,6	Ø 32	Ø 35
RECORD		FD-21FRE	FD-02FRE	FD-03FRE
VELOCE		FD-21FVL	FD-02FVL	FD-03FVL
MIRAGE		FD-01FMI	FD-02FMI	FD-03FMI
AVANTI		FD-01FAV		

# TECHNICAL SPECS 1995 PRODUCT RANGE

**PRODUCT:** TRIPLE FRONT DERAIL. BRAZE-ON

**DATE:** SET - 1995

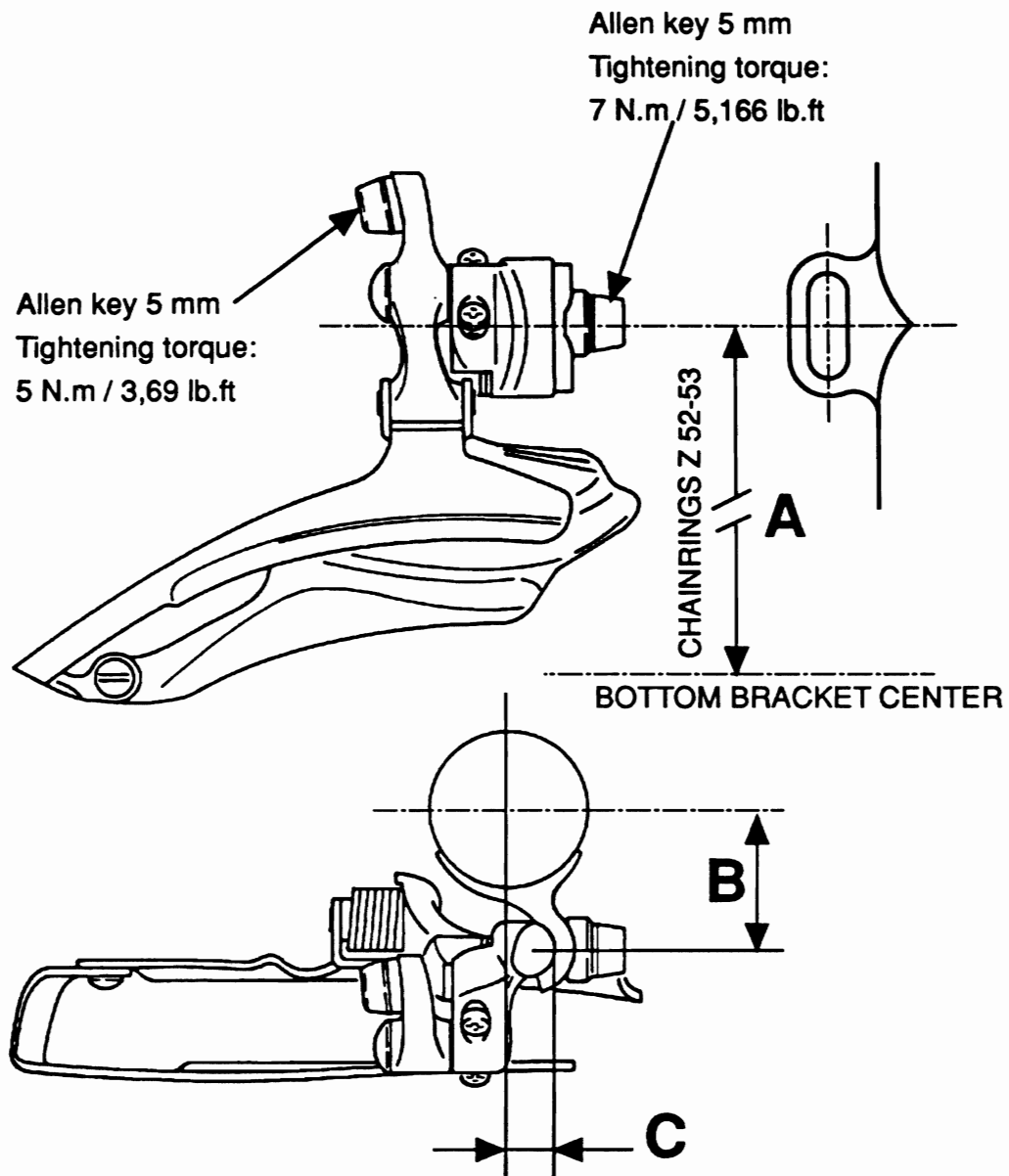

TYPE	A	B	C
RACING T - FD-01SRA3	148	24,75	9,5
VELOCE T - FD-01SVL3	148	24,75	9,5
MIRAGE T - FD-01SMI3	148	24,75	9,5

# TECHNICAL SPECS 1995 PRODUCT RANGE

**PRODUCT:** TRIPLE FRONT DERAIL. CLIP-ON

**DATE:** SET - 1995

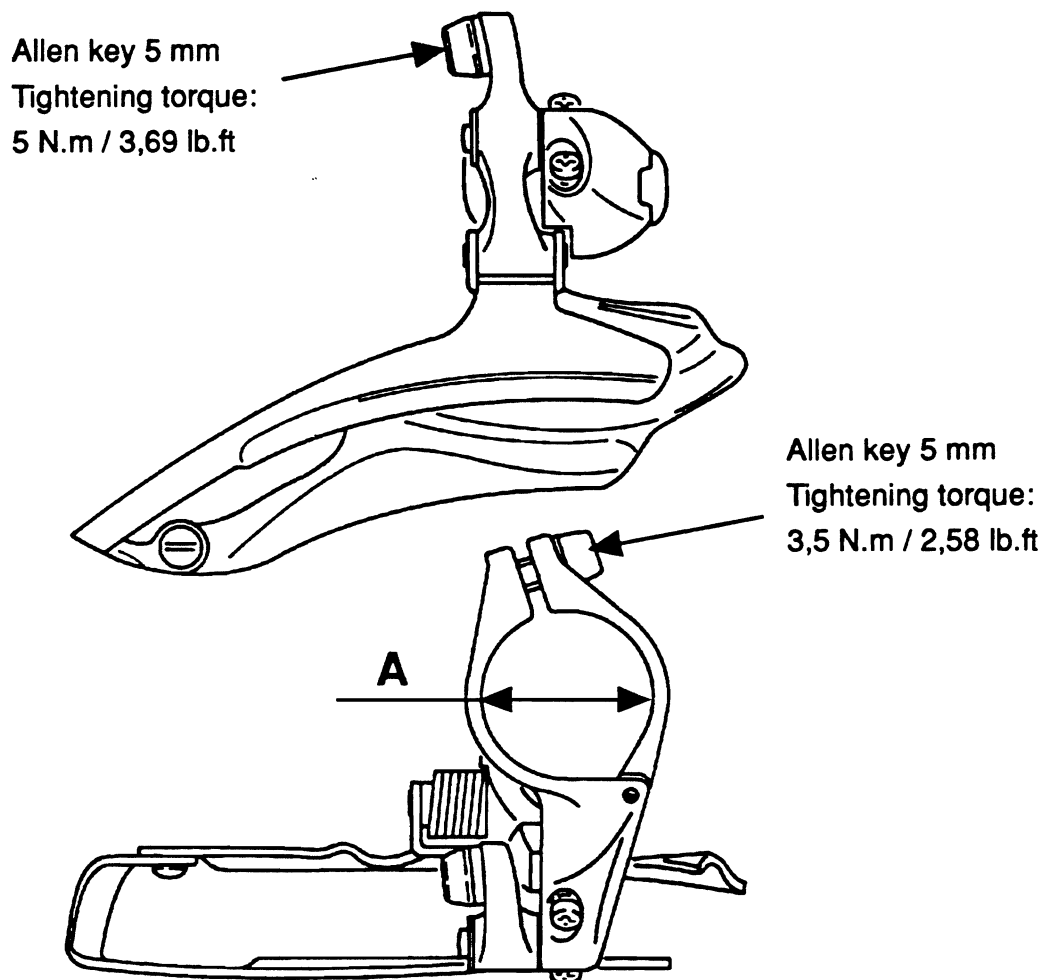

TYPE	A	Ø 28,6	Ø 32	Ø 35
RACING T		FD-01FRA3	FD-02FRA3	FD-03FRA3
VELOCE T		FD-01FVL3	FD-02FVL3	FD-03FVL3
MIRAGE T		FD-01FMI3	FD-02FMI3	FD-03FMI3

# TECHNICAL SPECS 1995 PRODUCT RANGE

**PRODUCT:** REAR DERAILLEUR

**DATE:** SET - 1995

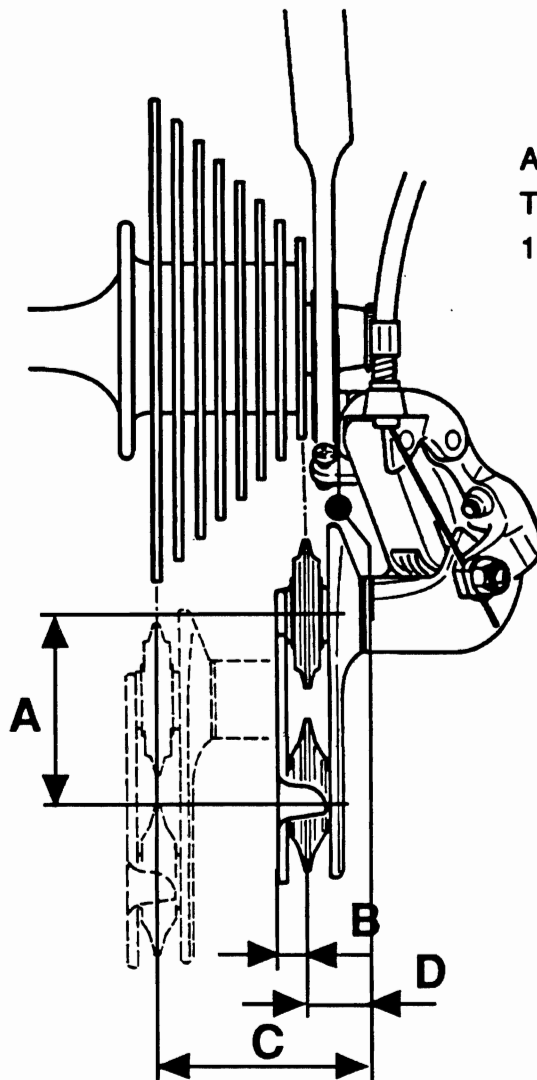

Allen key 5 mm  
Tightening torque:  
15 N.m / 11,07 lb.ft

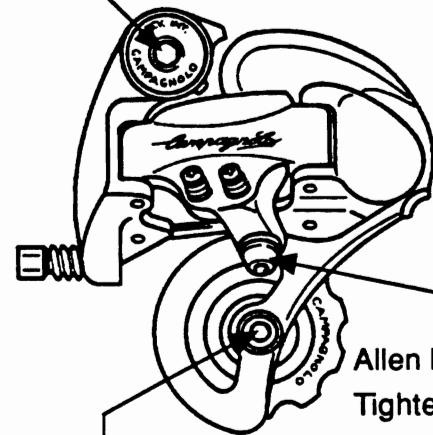

Allen key 5 mm  
Tightening torque:  
6 N.m / 4,43 lb.ft

Allen key 4 mm  
Tightening torque:  
3 N.m / 2,21 lb.ft

TYPE	A	B	C	D
RECORD - RD-31RE	46	7,5	45+52	11+14
CHORUS - RD-31CH	46	7,5	46+51	11+14
ATHENA - RD-31AT	46	7	46+51	11+14
VELOCE - RD-21VL	46	7	46+51	11+14
MIRAGE - RD-01MI	46	7	46+51	11+14
AVANTI - RD-01AV	46	7	46+51	11+14

# TECHNICAL SPECS 1995 PRODUCT RANGE

**PRODUCT:** TRIPLE REAR DERAILLEUR

**DATE:** SET - 1995

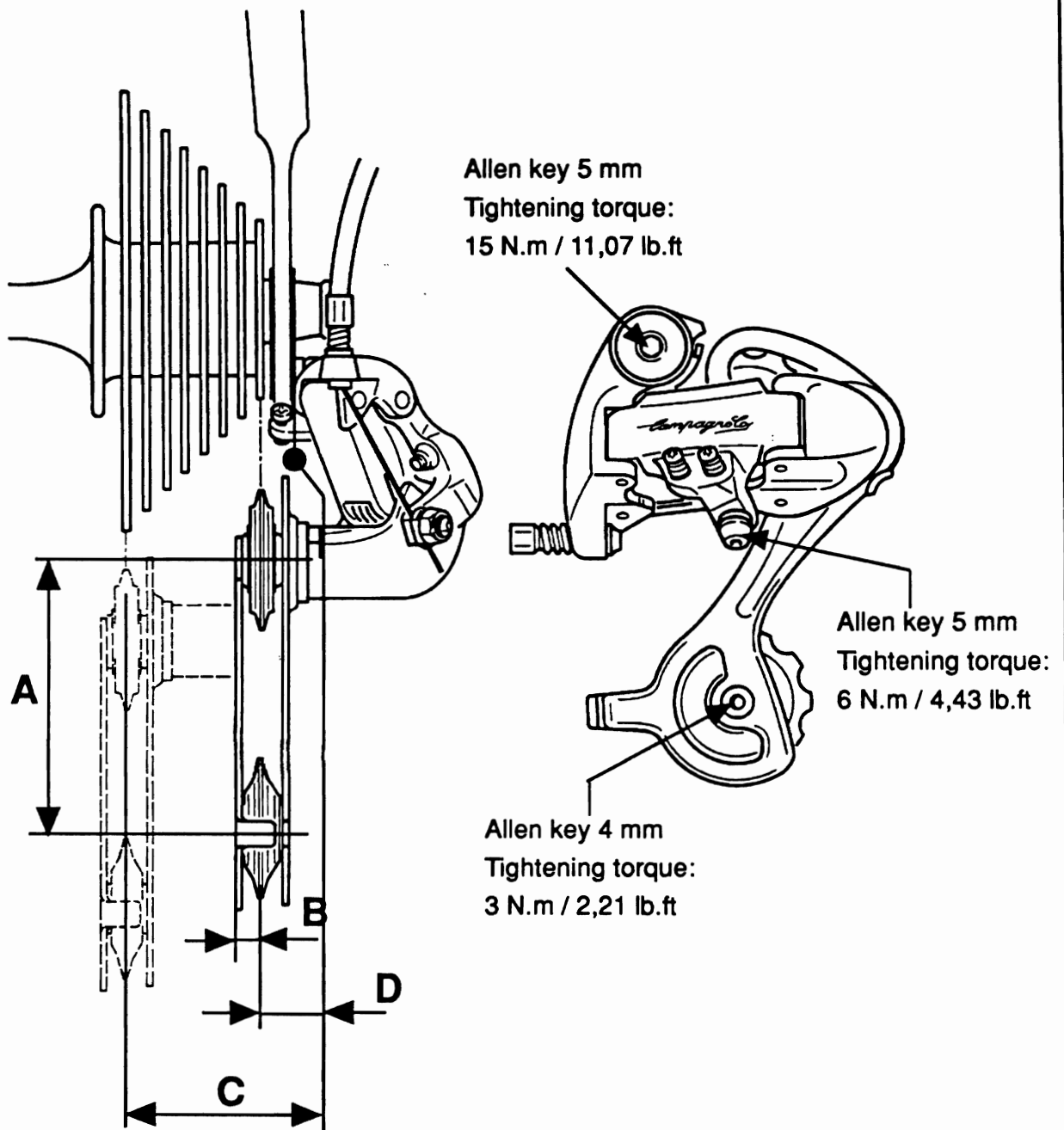

TYPE	A	B	C	D
RACING T - RD-01RA3	75	7	46+51	11+14
VELOCE T - RD-01VL3	75	7	46+51	11+14
MIRAGE T - RD-01MI3	75	7	46+51	11+14

# TECHNICAL SPECS 1995 PRODUCT RANGE

**PRODUCT:** FRONT HUB

**DATE:** SET - 1995

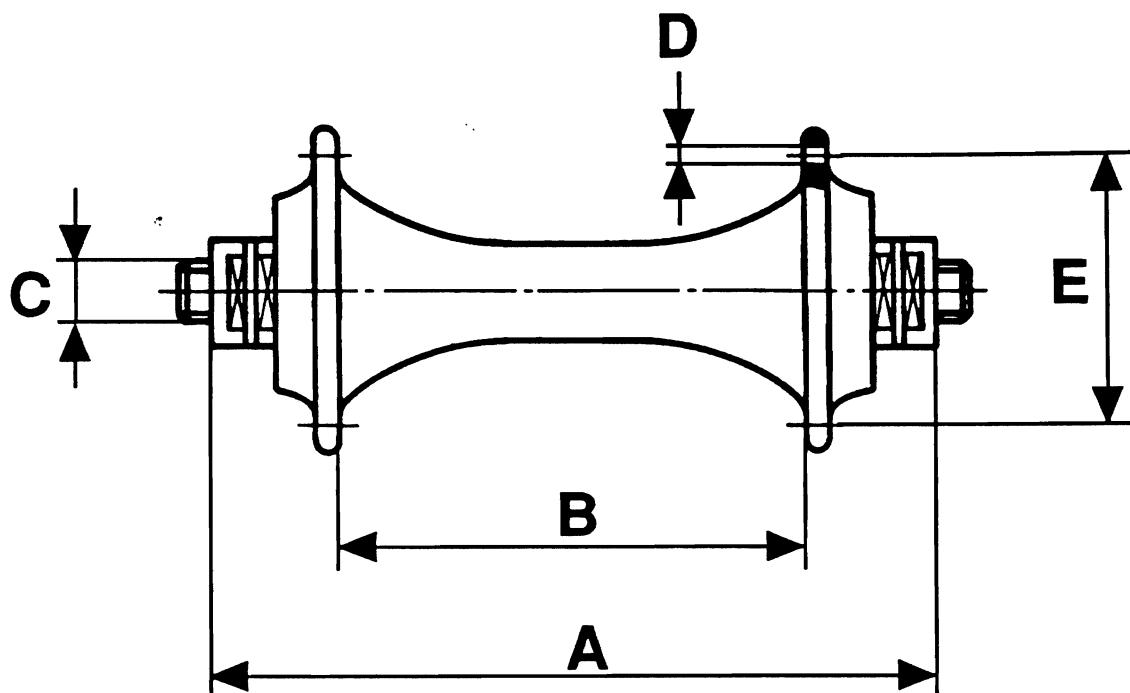

TYPE	A	B	C	D	E
RECORD - HB-10RE	100	65	9	2,4	38,5
CHORUS - HB-00CH	100	65	9	2,6	38,5
ATHENA - HB-20AT	100	65	9	2,6	38,5
VELOCE - HB-10VL	100	65	9	2,6	38,5
MIRAGE - HB-00MI	100	64	9	2,7	40

# TECHNICAL SPECS 1995 PRODUCT RANGE

**PRODUCT:** FREEHUB - SPROCKETS

**DATE:** SET - 1995

Campagnolo tool: 7130036

Tightening torque: 50 N.m / 36,9 lb.ft

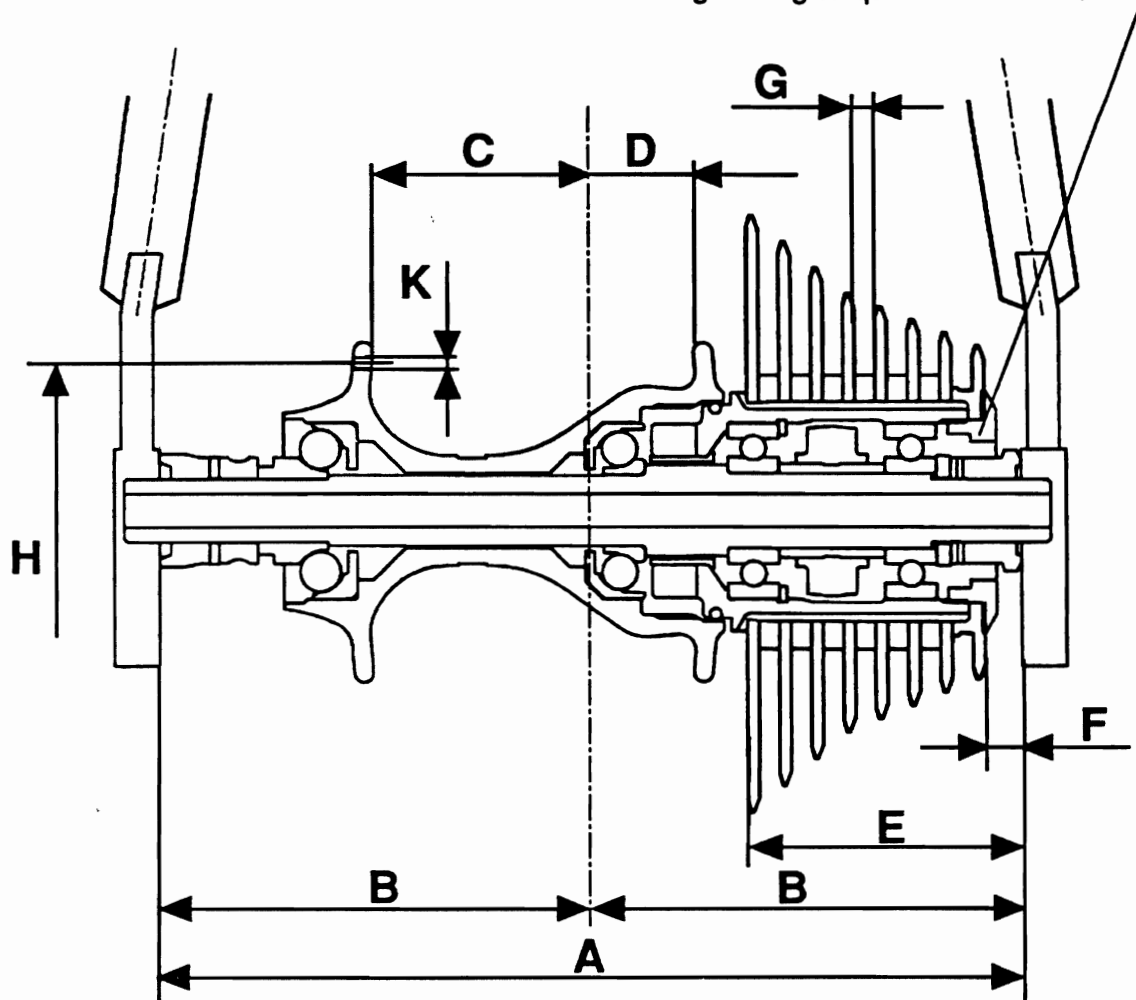

TYPE	A	B	C	D	E	F	G	H	K
RECORD - FH-20RE	130	65	34,9	15,1	41,5	4,3	3,2	44	2,4
CHORUS - FH-00CH	130	65	34,9	15,1	41,5	4,3	3,2	44	2,6
ATHENA - FH-20AT	130	65	34,9	15,1	41,5	4,3	3,2	44	2,6
VELOCE - FH-10VL	130	65	34,9	15,1	41,5	4,3	3,2	44	2,6
MIRAGE - FH-00MI	130	65	34,9	15,1	41,5	4,3	3,2	44	2,6
AVANTI - FH-00AV	130	65	34,9	15,1	41,5	4,3	3,2	44	2,6

# TECHNICAL SPECS 1995 PRODUCT RANGE

**PRODUCT:** ERGOPOWER CONTROL LEVERS

**DATE:** SET - 1995

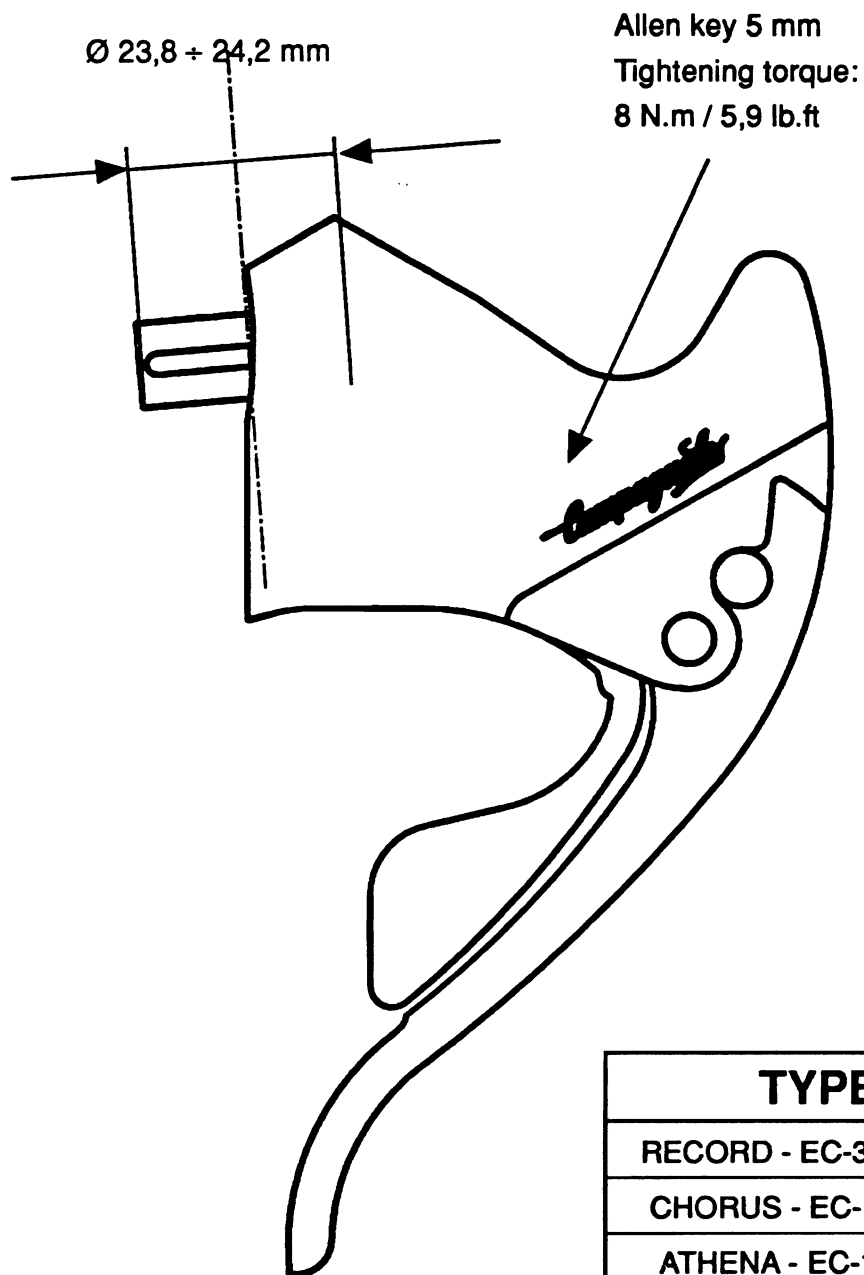

TYPE
RECORD - EC-32RECGC
CHORUS - EC-12CHCG
ATHENA - EC-12ATCG
VELOCE - EC-22VLCG
MIRAGE - EC-02MICG
AVANTI - EC-02AVCG



# TECHNICAL SPECS 1995 PRODUCT RANGE

PRODUCT: BRAKE LEVERS

DATE: SET - 1995

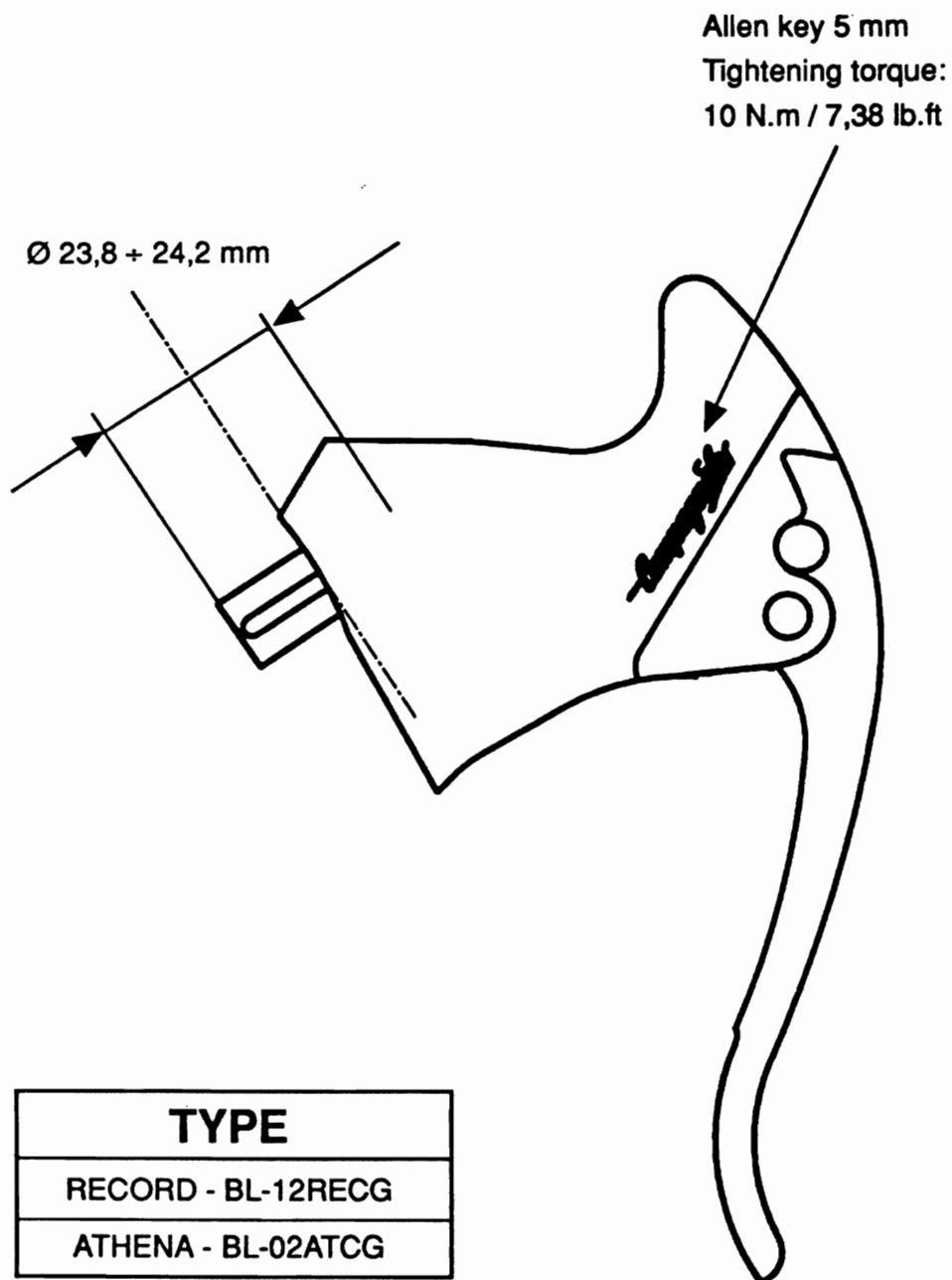

# TECHNICAL SPECS 1995 PRODUCT RANGE

**PRODUCT:** SHIFTING LEVERS

**DATE:** SET - 1995

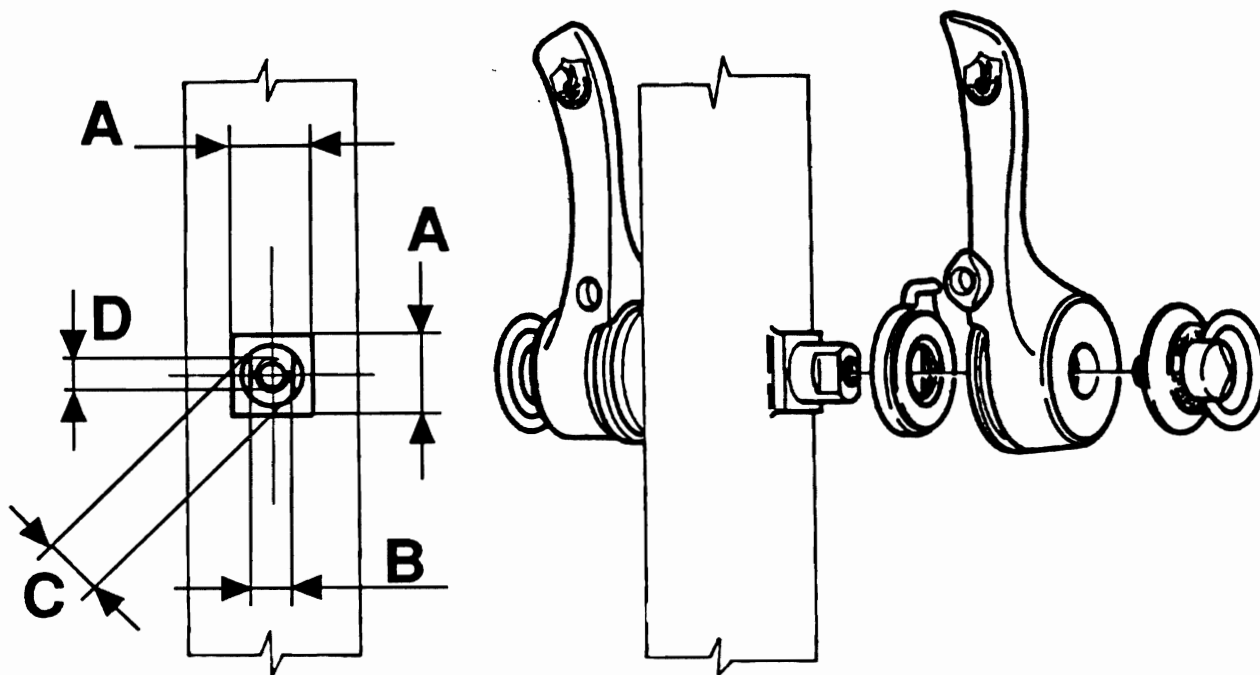

TYPE	A	B	C	D
RECORD - SL-11SRECG	12	5,85	M5 x 0,8	Ø 9
VELOCE - SL-11SVLCG	12	5,85	M5 x 0,8	Ø 9

# TECHNICAL SPECS 1995 PRODUCT RANGE

**PRODUCT:** BRAKES

**DATE:** SET - 1995

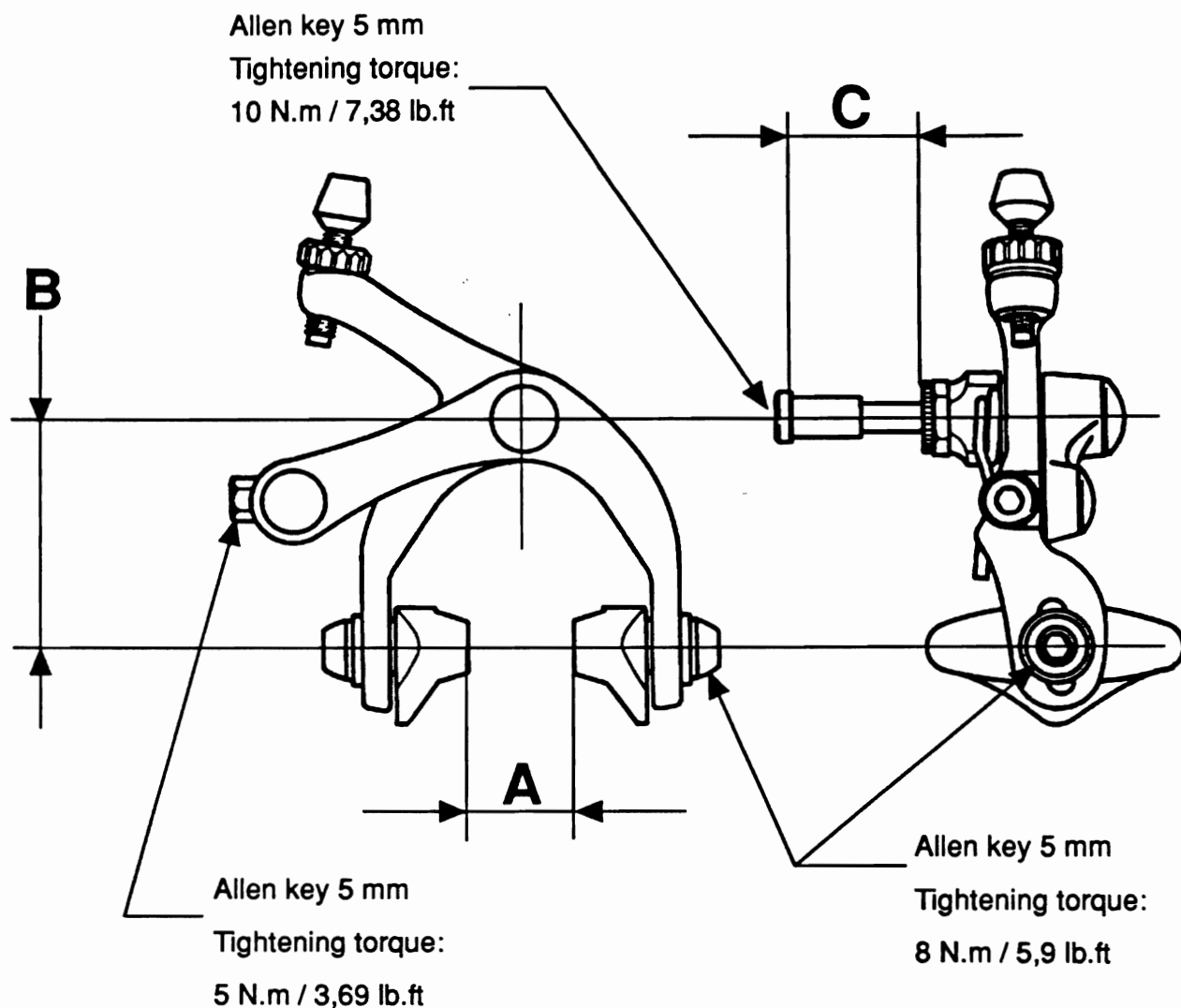

TYPE	A	B	C FRONT	C REAR
RECORD - BR-14RE	22	39+50	Min. 11,5-Max. 15	Min. 26-Max. 32
CHORUS - BR-22CH	22	39+50	Min. 11,5-Max. 15	Min. 26-Max. 32
ATHENA - BR-22AT	22	40+51,5	Min. 11,5-Max. 15	Min. 26-Max. 32
VELOCE - BR-12VL	22	40+51,5	Min. 11,5-Max. 15	Min. 26-Max. 32
MIRAGE - BR-02MI	22	39+51	Min. 11,5-Max. 15	Min. 26-Max. 32
AVANTI - BR-02AV	22	39+51	Min. 11,5-Max. 15	Min. 26-Max. 32

# TECHNICAL SPECS 1995 PRODUCT RANGE

**PRODUCT:** SEAT POST

**DATE:** SET - 1995

Allen key 6 mm  
Tightening torque:  
22 N.m / 16,23 lb.ft

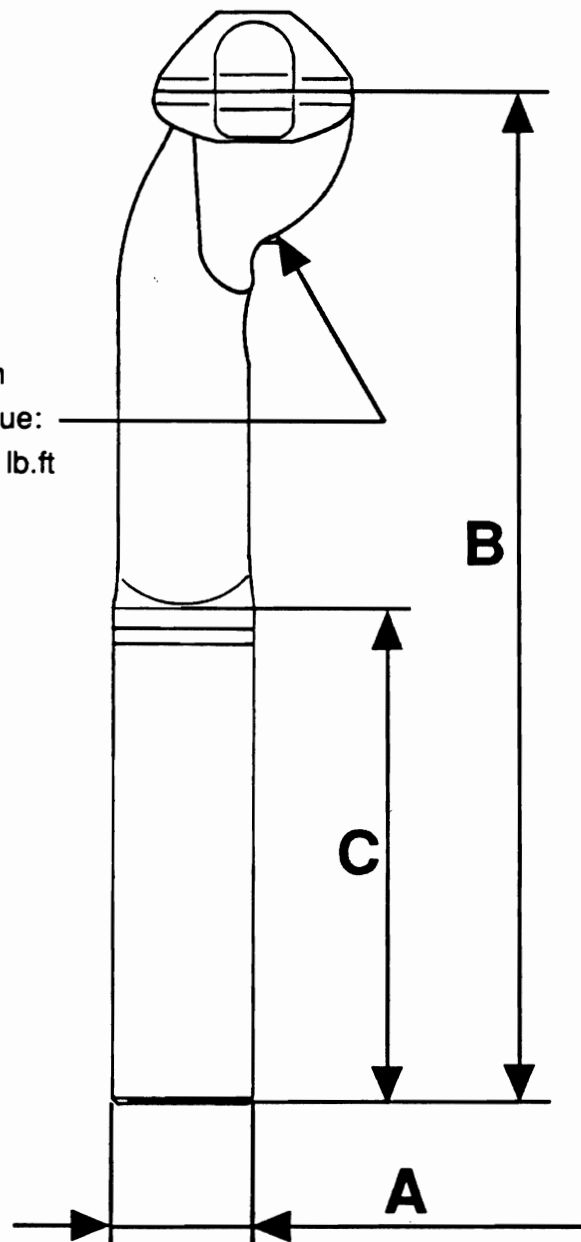

TYPE	A	B	C
RECORD - SP-10RE	Ø 27 - 27,2	210	170
CHORUS - SP-10CH	Ø 25-26,8-27-27,2	210	100
ATHENA - SP-10AT	Ø 26-26,4-26,6-26,8-27-27,2	204	100

# TECHNICAL SPECS 1995 PRODUCT RANGE

**PRODUCT:** PEDALS

**DATE:** SET - 1995

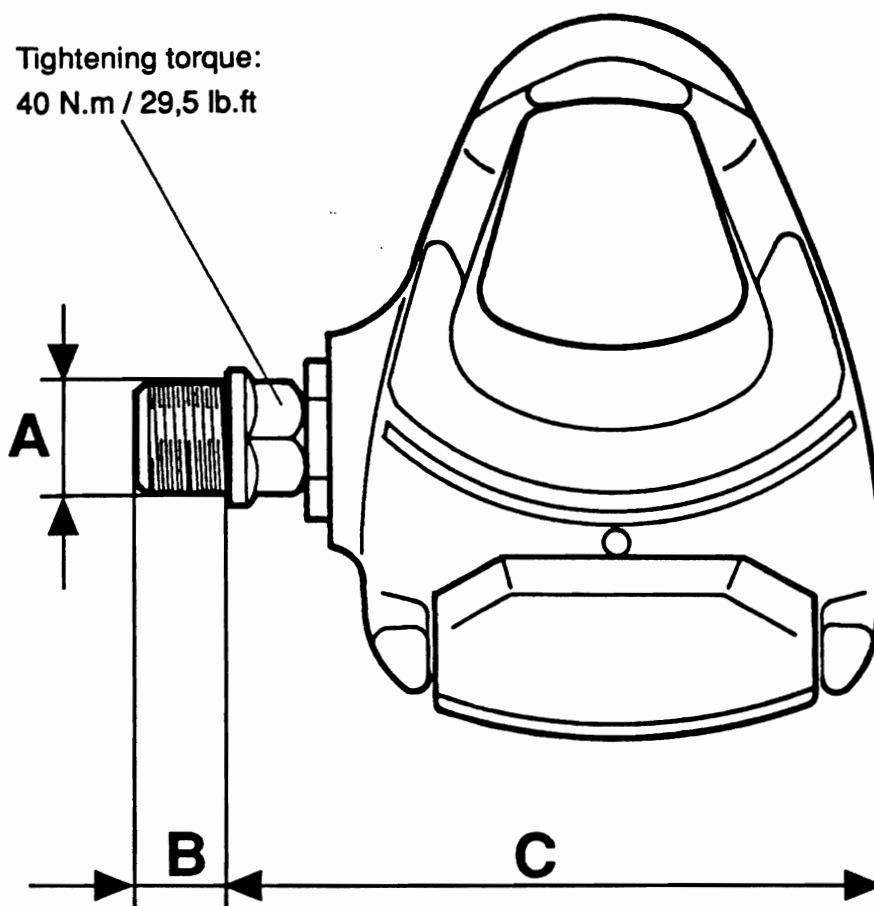







TYPE	A	B	C
RECORD - PD-32REQR	9/16" x 20 tpi	13	81
CHORUS - PD-32CHQR	9/16" x 20 tpi	12	80
ATHENA - PD-32ATQR	9/16" x 20 tpi	12	80
VELOCE - PD-22VLQR	9/16" x 20 tpi	12	80
MIRAGE - PD-02MIQR	9/16" x 20 tpi	12	80
AVANTI - PD-02AVQR	9/16" x 20 tpi	12	84

# TECHNICAL SPECS 1995 PRODUCT RANGE

**PRODUCT:** CABLES AND CASINGS

**DATE:** SET - 1995

BRAKES		FRONT	REAR		
		DIA. 1,6 mm L. 800 mm	DIA. 1,6 mm L. 1600 mm		
		DIA. 5 mm L. 580 mm	DIA. 5 mm L. 1250 mm		
		DIA. 6 mm			
DERAILLEURS	 DIA. 1,2 mm	ERGOPOWER		SHIFTING LEVERS	
		FRONT	REAR	FRONT	REAR
		L. 1600mm	L. 2000mm	L. 830mm	L. 1600mm
		ERGOPOWER		REAR DERAILLEUR	
		DIA. 4,5 mm L. 680 mm (x2)		DIA. 4,5 mm L. 330 mm	
	 DIA. 5,7 mm	 DIA. 5,7 / 4 mm			