

Campagnolo®

FRONT DERAILLEUR



**WARNING!**

Carefully read, follow and understand the instructions given in this manual. It is an essential part of the product, and you should keep it in a safe place for future reference.

MECHANIC QUALIFICATION - Please be advised that many bicycle service and repair tasks require specialized knowledge, tools and experience. General mechanical aptitude may not be sufficient to properly service or repair your bicycle. If you have any doubt whatsoever regarding your service/repair ability, please take your bicycle to a qualified repair shop.

"AN ACCIDENT" - Please note that throughout this manual, reference is made that "an accident" could occur. Any accident could result in damage to your bicycle, its components and, more importantly, could cause you or a bystander to sustain severe personal injury or even death.

INTENDED USE - This Campagnolo® product is designed and manufactured for use only on road racing style bicycles that are ridden only on smooth road or track surfaces. Any other use of this product, such as off-road or on trails is forbidden.

LIFESPAN - WEAR - INSPECTION REQUIREMENT - The lifespan of Campagnolo® components depends on many factors, such as rider size and riding conditions. Impacts, falls, improper use or harsh use in general may compromise the structural integrity of the components and significantly reduce their lifespan. Some components are also subject to wear over time. Please have your bicycle regularly inspected by a qualified mechanic for any cracks, deformation, signs of fatigue or wear (use of penetrating fluid or other visual enhancers to locate cracks on parts is recommended). If the inspection reveals any deformation, cracks, impact marks or stress marks, no matter how slight, immediately replace the component; components that have experienced excessive wear also need immediate replacement. The frequency of inspection depends on many factors; check with your authorized Campagnolo® representative to select a schedule that is best for you.



If you weigh 82 kg/180 lbs or more, you must be especially vigilant and have your bicycle inspected more frequently (than someone weighting less than 82 kg/180 lbs) for any evidence of cracks, deformation, or other signs of fatigue or stress. Check with your mechanic to discuss whether the components you selected are suitable for your use, and to determine the frequency of inspections.

The components of Campagnolo® 10s and 11s transmissions, as well as the brakes, rims, pedals and all other Campagnolo® products are designed as a single integrated system. Not to affect safety, performance, longevity, functionality and the WARRANTY, use exclusively the parts and components supplied or specified by Campagnolo S.r.l., without interfacing or replacing them with products, parts or components manufactured by other companies.

Note: Tools supplied by other manufacturers for components similar to Campagnolo® components, may not be compatible with Campagnolo® components. Likewise, tools supplied by Campagnolo s.r.l. may not be compatible with components supplied by other manufacturers. Always check with your mechanic or the tool manufacturer to insure compatibility before using tools supplied by one manufacturer on components supplied by another.

The user of this Campagnolo® product expressly recognizes that there are risks inherent in bicycle riding, including but not limited to the risk that a component of the bicycle can fail, resulting in an accident, personal injury or death. By his purchase and use of this Campagnolo® product, the user expressly, voluntarily and knowingly accepts and/or assumes these risks, including but not limited to the risk of passive or active negligence of Campagnolo s.r.l. or hidden, latent or obvious defects in the product, and agrees to hold Campagnolo s.r.l. harmless to the fullest extent permitted by law against any resulting damages.

SAFETY RECOMMANDATIONS

- Never make any modifications whatsoever to any component of any Campagnolo® product.
- Parts which have been bent or otherwise damaged in an accident or as a result of any other impact must not be re-straightened. They must be replaced immediately with original Campagnolo® parts.
- Wear clothes which are snug-fitting and which make you visible to traffic, such as neon fluorescent or other bright colors.
- Avoid biking at night because it is more difficult for you to be seen by traffic, and it is more difficult for you to see obstructions on the ground. If you do ride at night, you should equip your bicycle with and use a headlight and a tail light.
- Never use a bicycle or bicycle component unless you are thoroughly familiar with its use and maintenance history. "Used" equipment may have been misused and abused, and can unexpectedly fail resulting in an accident.
- Always wear a properly fitted and fastened bicycle helmet that has been approved by ANSI or SNELL.

If you ever have any questions, please contact your mechanic or your nearest Campagnolo® dealer for additional information.



BEFORE EVERY RIDE

**DO NOT RIDE YOUR BICYCLE IF IT DOES NOT PASS THIS PRE-RIDE TEST
CORRECT ANY CONDITION BEFORE YOUR RIDE.**

- Be sure that all of the components of your bicycle, including but not limited to your brakes, pedals, handgrips, handlebars, frame and seating system, are in optimum condition and suitable for use.
- Be sure that none of the components of bicycle are bent, damaged or out of alignment.
- Check you brake pads and cables to be sure they are in good condition.
- Test your brakes in the beginning of your ride to make sure that they are operating properly.
- Learn and follow the local bicycle laws and regulations, and obey all traffic signals, signs and laws while you ride.

If you ever any comments, questions or concerns, please contact your nearest Campagnolo Service Center. A list of service centers may be found on our website at www.campagnolo.com.

**WARNING!**

Check all gears work perfectly. While using the bike with the sprockets / chainrings at opposite extremes some noisiness is possible and the performance of the transmission is not the best.

1 - PRE-ASSEMBLY CHECKS**WARNING!**

Always wear protective gloves and glasses while working on the front derailleur.

**CAUTION!**

To get the best from shifting, adjusting the derailleur is **SOMEWHAT DIFFERENT** from the previous system, it is therefore necessary to read the following instructions **CAREFULLY**.

- Check the crankset is fitted correctly.
- Check the derailleur is compatible with your frame.

2 - FRONT DERAILLEUR INSTALLATION

CLIP-ON DERAILLEUR: loosen the screw using a 5 mm Allen wrench (A - Fig. 1), open the clip completely and clamp it onto the frame.

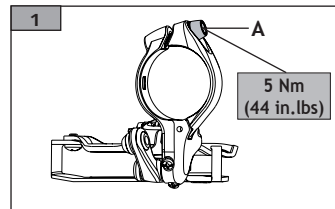

BRAZE -ON DERAILLEUR: loosen the screw using a 5 mm Allen wrench (A - Fig. 2) and remove the screw together with the washers, then secure the derailleur on the frame's braze-on coupling.

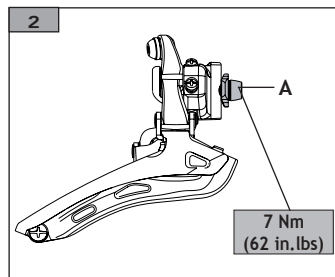

• Adjust the height of the derailleur so that the cage is at a distance of 1,5÷3 mm from the larger chainring (Fig. 3).

• **Align the derailleur:** the inner side of the derailleur cage must be parallel with the chainring (Fig. 4).

• Using a torque wrench, fasten the tightening bolt (Fig. 1/2 pos. A) to the frame, torquing to the following values:

- **7 Nm (62 in.lbs)** for braze-on versions
- **5 Nm (44 in.lbs)** for clamp-on versions.



WARNING!

If your frame is made of carbon fiber, contact the frame manufacturer to insure that the frame will not be damaged by this 5 Nm (44 in.lbs) tightening torque, or to determine what actions need to be taken to protect the frame from damage.

Even slight damage to a carbon fiber frame can result in an unexpected failure, resulting in an accident, personal injury or death.

• Install the chain and position it on the smaller chainring and larger sprocket.

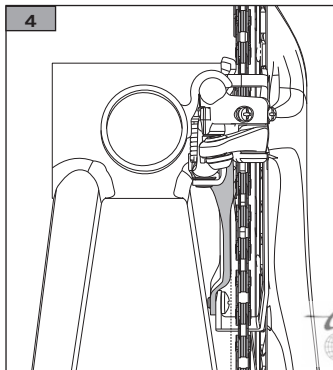
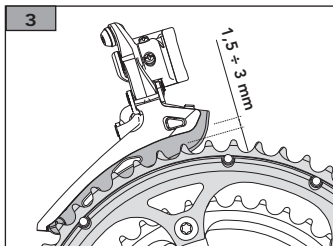

Campy
bike

3 - ADJUSTING THE FRONT DERAILLEUR

3.1 - LOWER POSITION

1) With the chain on the smallest gear and on the biggest sprocket, adjust the internal travel limit screw (B - Fig. 5) so that the inside face of the derailleur fork is **0.5 mm** from the internal side of the chain (Fig. 5).

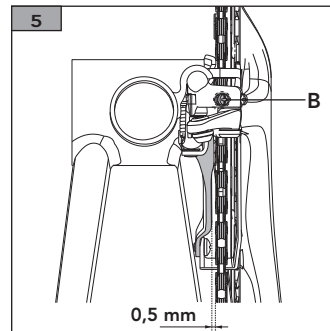

2) Install the cable and pull it moderately. Position it on the spline underneath the washer (C - Fig. 6) and tighten at **5 Nm (44 in.lbs)** with a 5 mm Allen wrench.

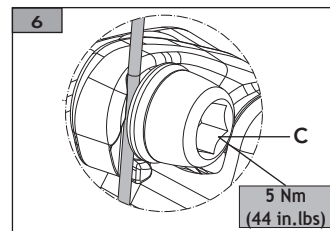

3) Set the transmission by pulling the cable moderately (Fig. 7). If it has lost tension, repeat points 1 and 2.

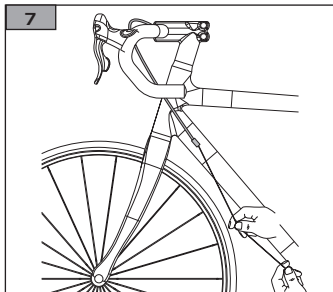

3.2 - UPPER POSITION

1) Leaving the chain on the biggest sprocket, shift operating the control **FOR 3 STEPS**.

2) Adjust the tension of the cable with the adjuster (E - Fig. 9) so that the inside face of the derailleur fork just skims the chain (**0.5 mm max**) (Fig. 8).

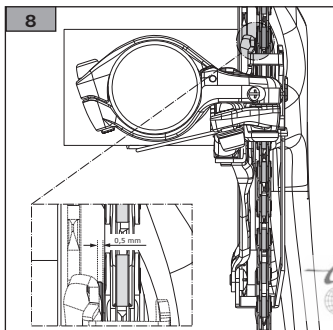

3) Adjust the external travel limit screw (D - Fig. 9) to bring it flush (Fig. 9).

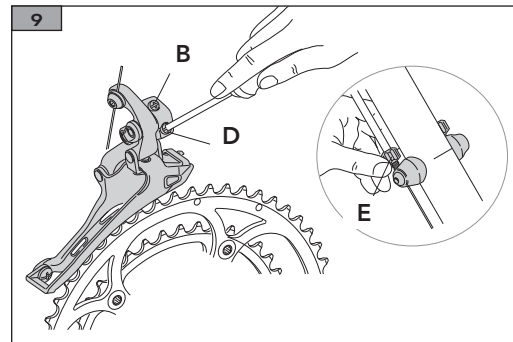

After adjusting the derailleur, test it and check the chain never goes down inside the smallest gear or outside the biggest one.

IMPORTANT!
THE DERAILLEUR MUST WORK IN 3 STEPS

4 - MAINTENANCE

- **Never remove the front derailleur spring from its seat.**

If this operation has been carried out, go to a Campagnolo Service centre to restore the front derailleur's functionality.

- Regularly lubricate all moving parts of the derailleur mechanism and make sure the derailleur bar moves freely.

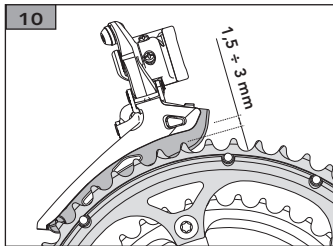

- Make sure that the derailleur is always properly adjusted:
 - Adjust the height of the derailleur so that the cage is at a distance of 1,5±3 mm from the larger chainring (Fig. 10)
 - the outside side of the derailleur cage must be parallel with the larger chainring (Fig. 4).
- Maintenance intervals are purely indicative and may be significantly different in relation to conditions of use and the intensity of your activity (for example: racing, rain, salted Winter roads, weight of the rider etc.). Check with your mechanic to select a schedule that is best for you.

- Salt, mud and sand seriously damage bicycles and their components. Thoroughly rinse, clean and dry your bike after using it in these conditions.
- Never spray your bicycle with water under pressure. Pressurized water, even from the nozzle of a small garden hose, can pass seals and enter into your Campagnolo® components, damaging them beyond repair. Wash your bicycle and Campagnolo® components by wiping them down with water and neutral soap. Dry them using a soft cloth. Never use abrasive or metal pads.

**WARNING!**

Salt water environments (as found on winter roads and near the seaside) can cause galvanic corrosion on most bike parts. Carefully rinse, clean, dry and re-lubricate all exposed parts to avoid corrosion, wear, damage, malfunctions and accidents.