

BREVETTI INTERNAZIONALI



catalogue n. 18 bis

INDEX

	page
THE COMPANY	4
ITS PRODUCTS	5
RECORD corsa group	6-7
RECORD track group	8-9
VICTORY corsa group	10-11
VICTORY leisure group	12-13
TRIOMPHE corsa group	14-15
TRIOMPHE leisure group	16-17
GEARS	18
C-RECORD gear	19
VICTORY corsa gear	20
VICTORY leisure gear	21
TRIOMPHE corsa gear	22
TRIOMPHE leisure gear	23
990 gear	24
FRONT CHANGERS	25
C-RECORD braze-on and clip-on front changers	26
VICTORY corsa braze-on and clip-on front changers	27
TRIOMPHE corsa front changers	29
TRIOMPHE leisure front changers	30
980 front changers	31
Gear control LEVERS	32
Gear control LEVERS COMPONENTS	33
HUBS sets	34
HUBS components	35
QUICK releases and relevant components	36
HEAD sets	37
CHAINWHEEL sets	38-39
CHAINWHEEL components	40
SEAT PINS	41
BOTTOM BRACKET sets	42
BOTTOM BRACKET set components	43
PEDALS sets	44
PEDALS components	45
BRAKES sets	46-47
RECORD BRAKE components	48-49
VICTORY and TRIOMPHE BRAKE components	50-51
RIMS	52
RIMS range	53
RIMS technology of performance	54

THE COMPANY

1927. Tullio Campagnolo, valid cyclist, punctures during a race on the Croce d'Aune pass.

Is it winter time: the cold, the snow and the frozen hands do not permit him to release the screws that fix the wheel to the frame.

Tullio Campagnolo loses the race, but that event is the push of a series of happy intuitions that in a few years radically change the bicycle and the cycling sport too.

Those times are now far away: today the most famous components in the world are produced by a leader Company that entrusts its performances to a valid managerial team, to its technicians' experience, to the qualifications of the employees, to its capacity to change and of updating its range of products.



ITS PRODUCTS

The vocation of the Company is certainly the production of bicycle components: Campagnolo is one of the very few Companies in the world that manufactures a complete ensemble and the only one that offers a production of exclusive quality.

All the parts as the hubs and the brakes, the gear and the chainset, the wheelworks and rims, but especially the small components such as the titanium screw for the gear and the seasoned rubber hoods for levers, witness the steady research of the quality, which is meant as safety, aesthetics, simplicity of solutions. A complete range of products which are the soul of the bicycle and which ennoble and mark it in an unmistakable way.



RECORD® corsa group

180 RECORD® corsa group

composed of: double spring gear 0102050, clip-on front changer 0104018, braze-on double control levers 0118071-0118072, gear cable 606, front changer cable 608, steel casing 617, small flange hubs set 322/101, chainset with incorporated extractor 306/101, bottom bracket set 303/101, pedals set complete with toe-clips and toe-straps 305/101, head set 304/104, seat pillar with one fixing screw 316/101, brakes set preset for the passage on the outer, lateral and inner cables, complete with cables and casings 315/101, fixing bolt and nut for sept pin Ø 8, art. 1072.

The RECORD Group: a unique and exclusive Group.

For those who demand the ultimate of themselves and of their bicycles.

Avant-garde appearance, clean lines, attention to every detail, shapes that are a challenge to the latest technology.

Brakes with a variable leverage, shifting levers with clutch mechanism, chainwheel arm incorporates with the crank: Campagnolo technology, style and reliability make the RECORD Group the top of the cycle components.

The brakes set 315/101 is not available when printing this catalogue. The group is equipped with a brake set of the Super Record family.



RECORD® pista group

182 C-RECORD® pista group

composed of: large flange hubs set 321/102, chainset 306/102, bottom bracket set 303/102, pedals set with toe-clips and toe-straps 305/101, head set 304/104, seat pillar with one fixing screw 316/101, fixing bolt and nut for set pin Ø 8, art. 1072.



VICTORY® corsa group set

269 VICTORY® group set in corsa version

composed of: rear gear with adjusting device of position for superior body, without hanger 0102045, clip-on front changer 0104020, double control levers, braze-on version 0118037-0118038 or clip-on version 0118060, small flange hubs 422/000, chain set with self extracting cranks 0355/000, bottom bracket set 403/100, pedals set with toe-clips and toe-straps 405/000, head set 404/000, styled seat pillar with one fixing screw 416/000, brakes with levers having a carved cable-ruck for quick cable replacement complete with outer cable 415/000.

VICTORY: a Group based on racing experience.

To equip prestigious competition bicycles, built to last.

Strikingly modern in appearance, with articulated parallelogram derailleurs, pedals with central axis, single action saddle adjustment.

All the classic Campagnolo technical features enhanced in a new Group of winning quality.

Campagnolo®



VICTORY® leisure group set

268 VICTORY® group set in leisure version

composed of: rear gear with position adjusting device for superior body, with long cage plate, without hanger 0102047, clip-on front changer, long fork 0104024, double control levers, braze-on version 0118037-0118038 or clip-on version 0118060, small flange hubs 422/000, chain set with self-extracting cranks 0355/000, bottom bracket set 403/100, pedals with toe-clips and toe-straps 405/000, head set 404/000, styled seat pillar with one fixing screw 416/000, brakes with levers having a carve cable-ruck for quick cable replacement complete with outer cable 415/000.

VICTORY: The Leisure version is for those who don't look for ultimate performances in riding, but who still want an exceptionally dependable machine.

VICTORY Leisure: large capacity long-arm changer for a more comfortable ride over hilly terrain.



TRIOMPHE® corsa group set

267 TRIOMPHE® group set in corsa version

composed of: rear gear without hanger 0102055, clip-on front changer 0104026, double control levers braze-on version 0118042-0118043 or clip-on version 0118061, small flange hubs 922/000, chain set with screw and washer for bottom bracket fitting 0365/000, bottom bracket set 903/100, pedals set with toe-clips and toe-straps 905/000, head set 904/000, styled seat pillar with one screw 416/000, brakes with levers and cables 915/000.

TRIOMPHE: Campagnolo technology reaches many lightweight racing bicycles.

For a wide open space sport, which is getting younger, year by year, in competition and in enjoyment.

Well tested technical solutions, a renewed tradition, an undisputed experience: the TRIOMPHE Group is signed Campagnolo.



TRIOMPHE® leisure group set

266 TRIOMPHE® group set in leisure version

composed of: rear gear without hanger, long cage plate 0102057, clip-on front changer, long fork 0104027, double control levers, braze-on version 0118042-0118043 or in clip-on version 0118061, small flange hubs 922/000, chain set with screw and washer for bottom bracket fitting 0365/000, bottom bracket set 903/100, pedals set with toe-clips and toe-straps 905/000, head set 904/000, styled seat pillar with one fixing screw 416/000, brakes with levers and cables 915/000.

TRIOMPHE: The Leisure version is for cycling enthusiasts who want lower, more "comfortable" gears.
"A TRIOMPHE Leisure bicycle": the bicycle to get on and go, to widen your horizons.
The bicycle one can't stop loving.

GEARS

0102050 «C-RECORD» gear
0102045 «VICTORY» corsa gear
0102047 «VICTORY» leisure gear
0102055 «TRIOMPHE» corsa gear
0102057 «TRIOMPHE» leisure gear
0102068 «990» gear

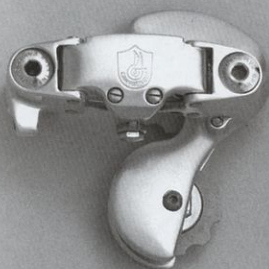

0102050



0102045

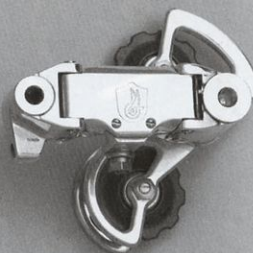

0102055

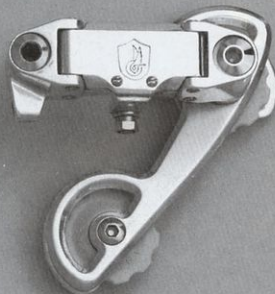

0102047

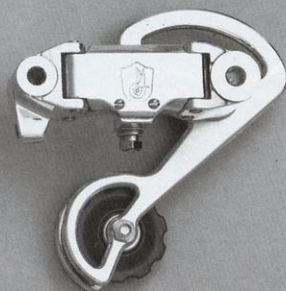

0102057



0102068

C-RECORD® gear

0102050 composed of:

0550/74 set (12) roller balls, 89 cable fixing screw, 1119005 front cage plate 2302007 roller, 7116053 ferrule, 7116059 bush, 7116064 upper body bush, 7117039 front arm, 7117040 inner arm, 7119032 inner cage plate, 7133041 male cone for roller, 7133042 female cone for roller, 7143373 lower body, 7143670 upper body, 7146016 roller dust cover, 7146018 roller dust cover with indentation, 7161117 roller fixing screw, 7260069 return spring, 7260076 cage plate rotation spring, 7260078 upper body spring, 7270003 clamp washer, 7287011 grub screw, 7319056 arm rivet, 7350142 gear hanger screw, 7350143 spring cage screw, 7350144 roller fixing screw, 7350201 adjusting screw, 7350202 bush clamp screw.

Roller 1302006 complete with: 0500/74-2302007, 7133041, 7133042, 7146016, 7146018.

REMARK: The roller is supplied only complete.

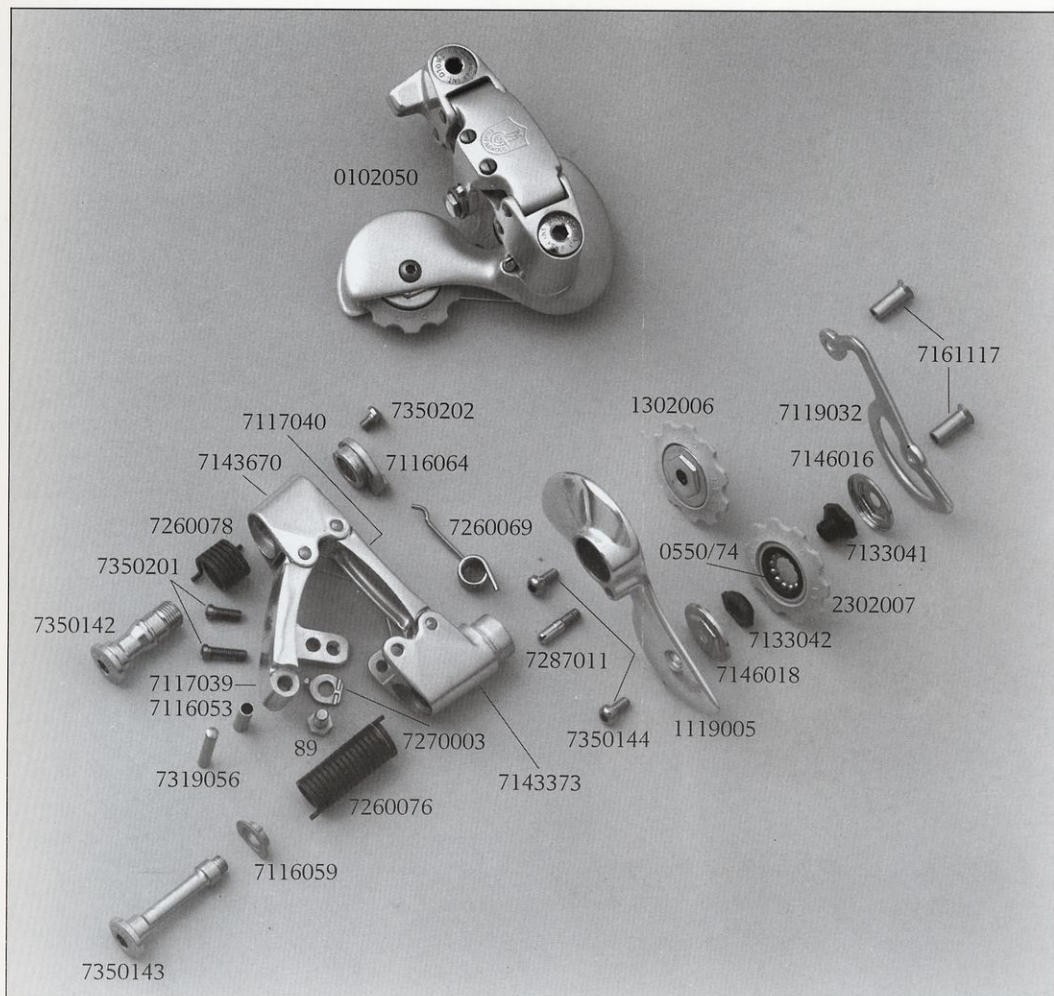

VICTORY® corsa gear

0102045 composed of:

1302005 gear roller, 7116059 bush, 7116067 upper body bush, 7116071 lower body ferrule, 7119024 front cage plate, 7119025 inner cage plate, 7161108 nut, 7200011 adjusting screw, 7260085 gear spring, 7300114 washer, 7350125 gear hanger screw, 7350126 spring cage screw, 7350165 gear fixing screw.

Parallelogram 1284011 complete with:

7116053 ferrule, 7117045 front arm, 7117046 inner arm, 7143359 lower body, 7143668 upper body, 7222025 insert for adjusting screws, 7260069 gear return spring, 7319932 pin, 7350119 gear cable fixing screw (the components of the parallelogram 1284011 are not supplied disassembled)

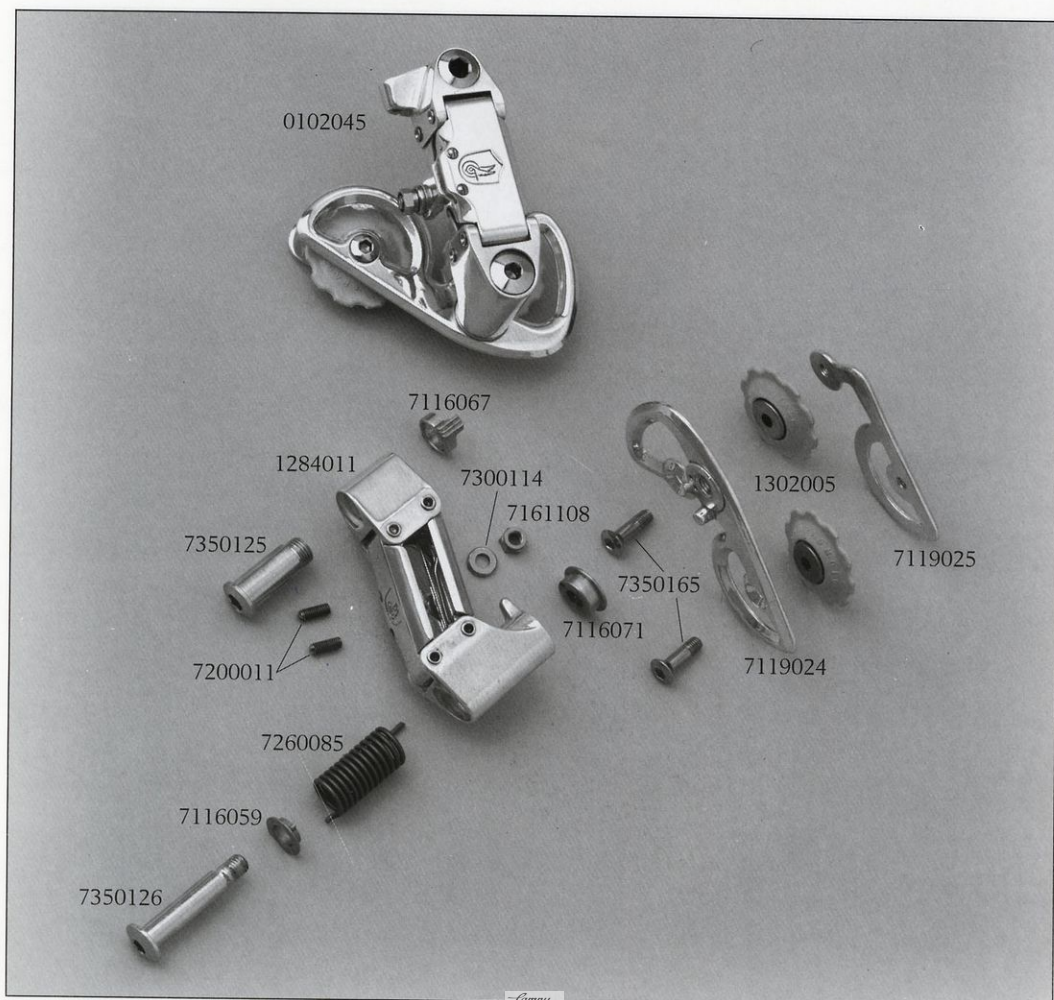

VICTORY® leisure gear

0102047 composed of:

1302005 gear roller, 7116059 bush, 7116067 upper body bush, 7116072 lower body ferrule, 7119026 front cage plate, 7119027 inner cage plate, 7161108 nut, 7200011 adjusting screw, 7260085 gear spring, 7300114 washer, 7350125 gear hanger screw, 7350163 spring cage screw, 7350164 roller screw for long cage plate, 7350165 roller fixing screw.

Parallelogram 1284011 complete with:

7116053 gear ferrule, 7117045 front arm, 7117046 inner arm, 7143359 lower body, 7143668 upper body, 7222025 insert for adjusting screws, 7260069 gear return spring, 7319032 pin, 7350119 gear cable fixing screw (the components of the parallelogram 1284011 are not supplied disassembled).

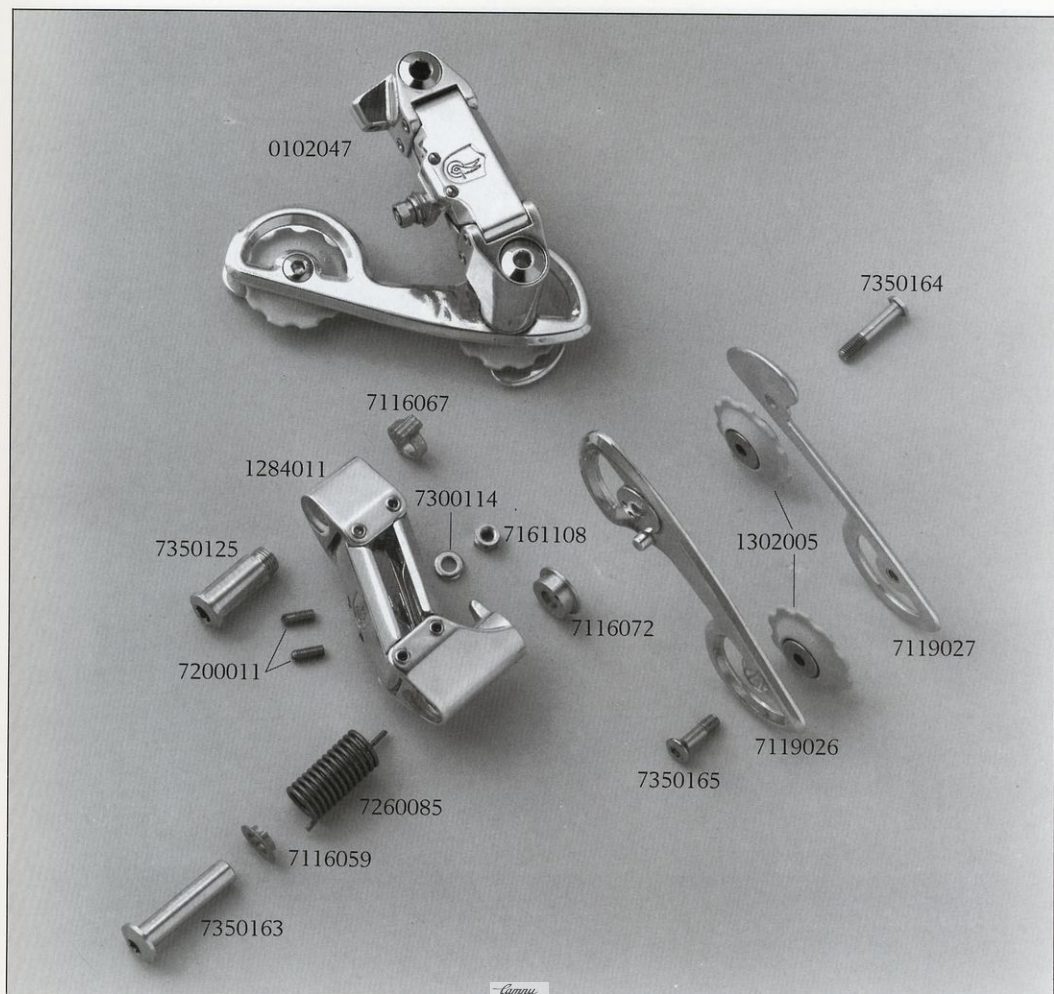

TRIOMPHE® corsa gear

0102055 composed of:

0010/03 roller, 139/1 nut, 7116054 bush, 7116071 lower body ferrule, 7119028 inner cage plate, 7119029 front cage plate, 7161108 cable fixing screw nut, 7200011 adjusting screw, 7260061 gear spring, 7300114 washer, 7350175 roller fixing screw, 7350180 gear hanger screw, 7350181 spring cage screw.

Parallelogram 1284012 complete with:

7116053 ferrule, 7117045 front arm, 7117046 inner arm, 7143358 upper body, 7143669 lower body, 7222025 insert for adjusting screws, 7260069 gear return spring, 7319032 screws, 7350119 cable fixing screw (the components of the parallelogram 1284012 are not supplied disassembled).

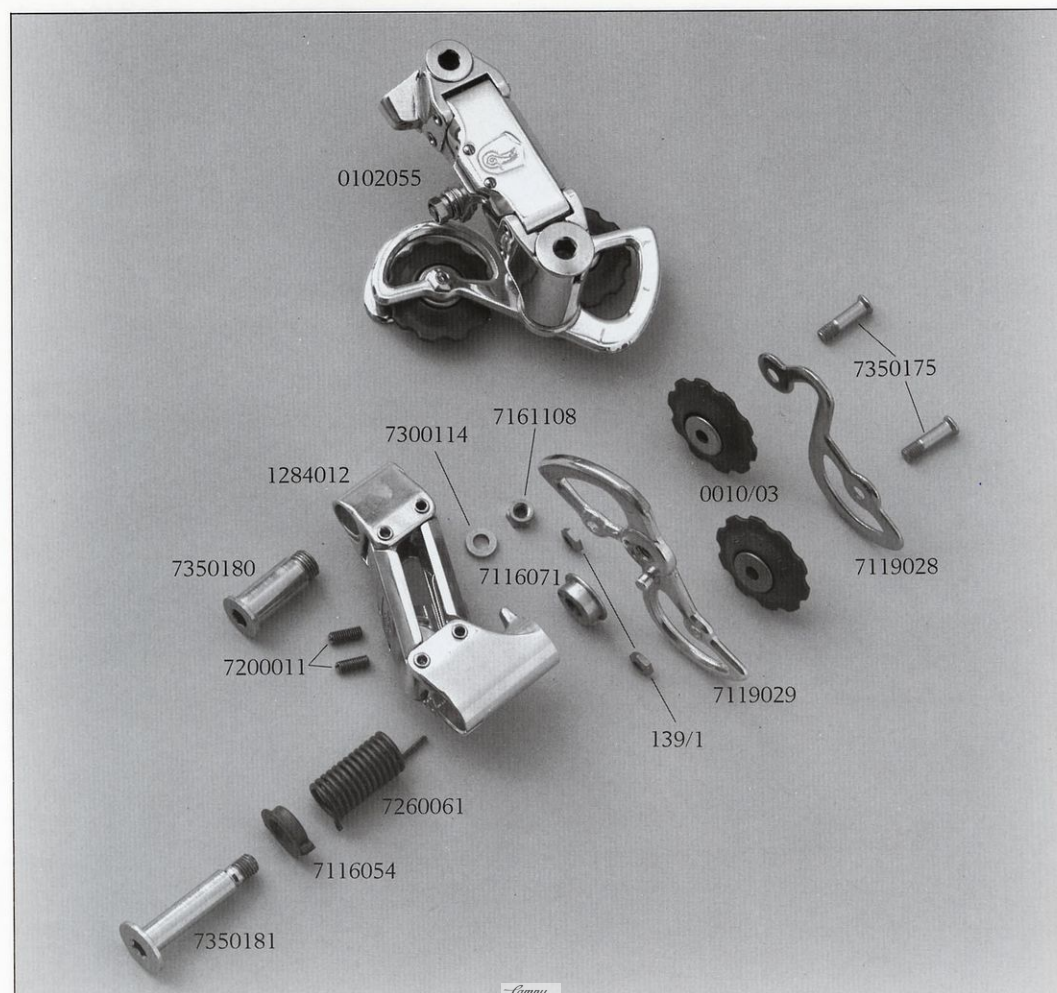

TRIOMPHE® leisure gear

0102057 composed of:

0010/03 gear roller, 139/1 nut, 7116054 bush, 7116072 lower body ferrule, 7119030 front cage plate, 7119031 inner cage plate, 7161108 cable fixing screw nut, 7200011 adjusting screw, 7160061 gear spring, 7300114 washer, 7350175 roller fixing screw, 7350180 gear hanger screw, 7350182 spring cage screw, 7350186 roller screw for long cage plate gear.

Parallelogram 1284012 complete with:

7116053 ferrule, 7117045 front arm, 7117046 inner arm, 7143358, upper body, 7143669 lower body, 7222025 insert for adjusting screw, 7260069 gear return spring, 7319032 screw, 7350119 cable fixing screw (the components of the parallelogram 1284012 are not supplied disassembled).

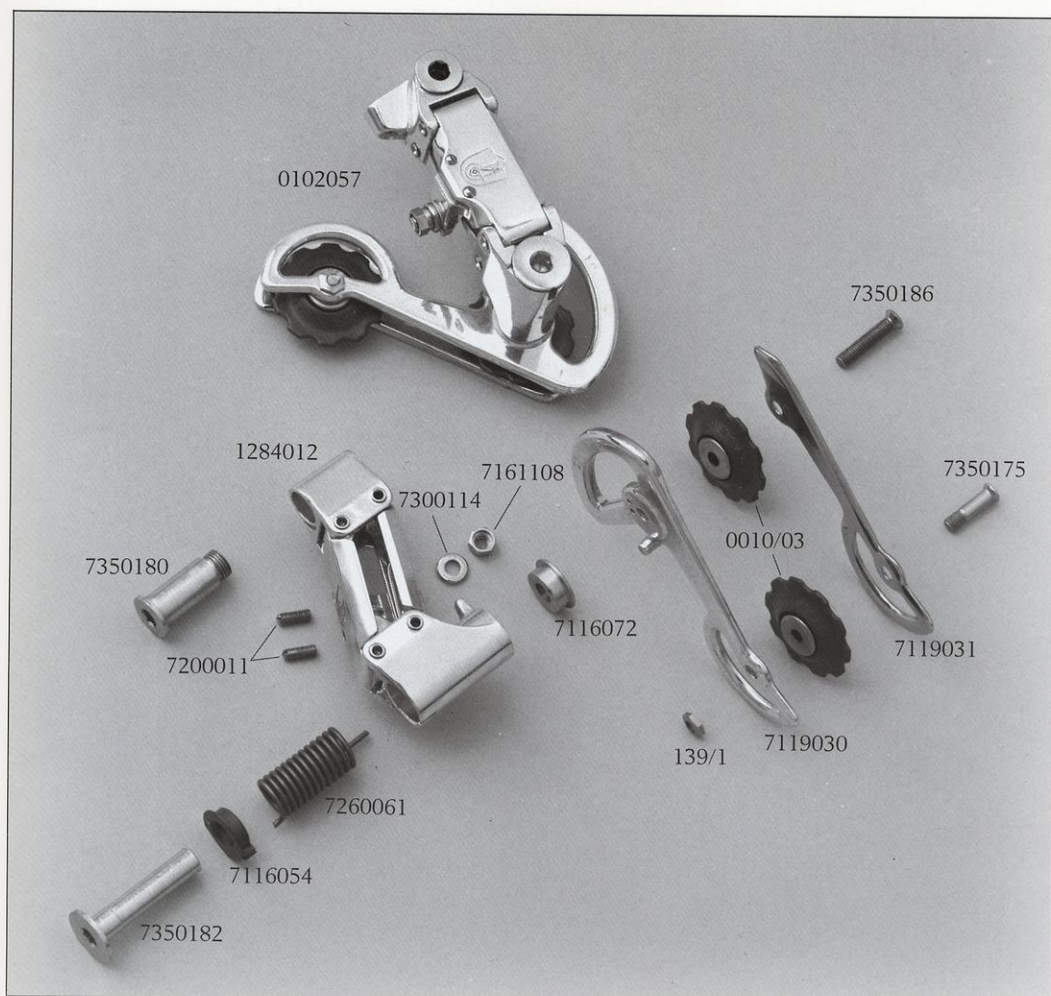

990 gear

0102068 composed of:

0010/03 gear roller, 93/A roller fixing screw, 7116054 bush, 7116055 ferrule, 7119014 inner cage plate, 7119020 front cage plate, 7161108 nut, 7200011 adjusting screw, 7260061 gear spring, 7300114 washer, 7350173 gear hanger screw, 7350174 cage plate screw.

Parallelogram 1284010 complete with:

7116059 ferrule, 7117024, inner arm, 7117034 front arm, 7143357 lower body, 7143679 upper body, 7222021 friction insert for adjusting screws, 7260069 gear return spring, 7319032 screw, 7350119 gear cable fixing screw (the components of the parallelogram 1284010 are not supplied disassembled).

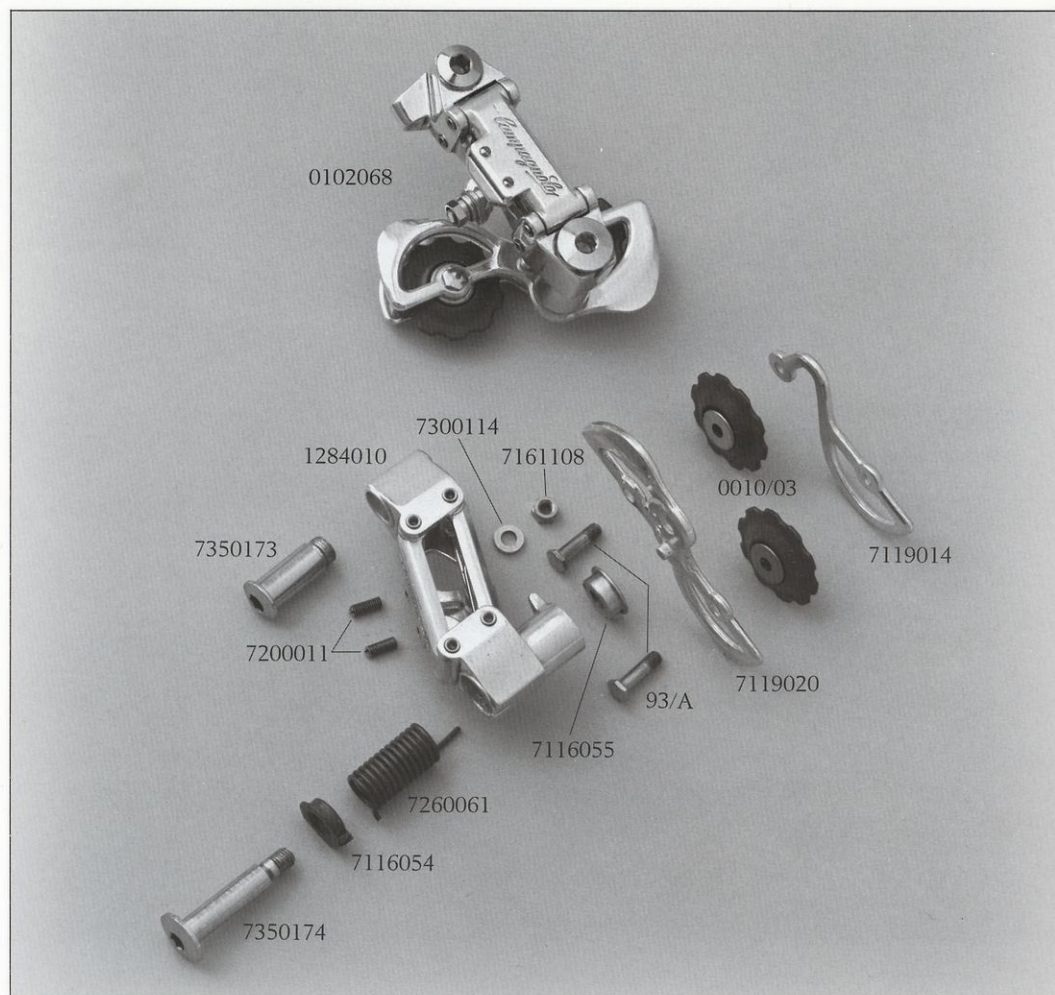

FRONT CHANGERS

- 0104018 «C-RECORD» clip-on front changer
- 0104019 «C-RECORD» braze-on front changer
- 0104020 «VICTORY» corsa clip-on front changer
- 0104021 «VICTORY» corsa braze-on front changer
- 0104024 «VICTORY» leisure clip-on front changer
- 0104025 «VICTORY» leisure braze-on front changer
- 0104026 «TRIOMPHE» corsa clip-on front changer
- 0104027 «TRIOMPHE» corsa braze-on front changer
- 0104012 «980» clip-on front changer
- 0104013 «980» clip-on large fork front changer

Remark: The bodies and the forks of the front changers are supplied only complete.

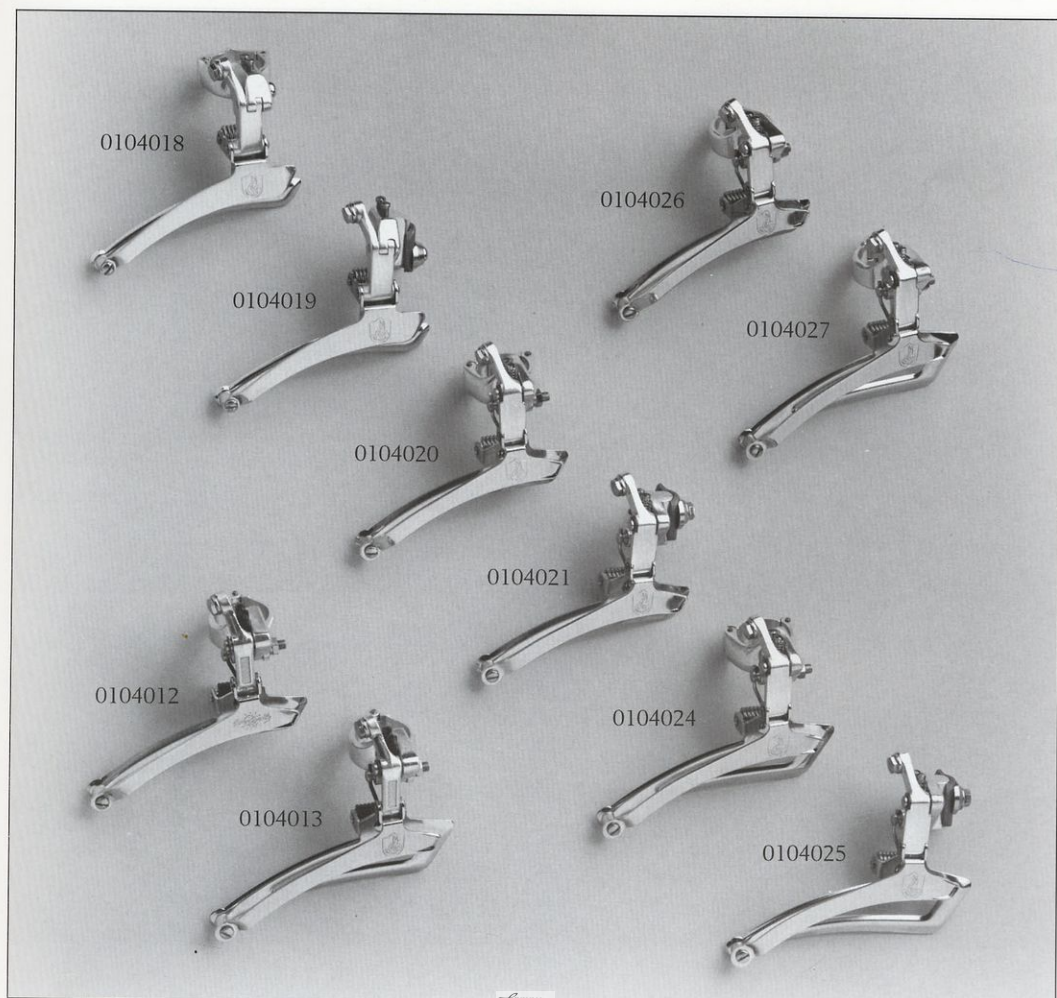

C-RECORD® braze-on and clip-on front changers

0104018 and 0104019 composed of:

89 cable fixing screw, 215 fork cage bolt, 217 nut, 790 bush, 7102012 braze-on boss, 7116057 lower arm bush, 7116060 cage spring bush, 7117041 front arm, 7117042 clip-on front changer inner arm, 7117055 braze-on front changer arm, 7161118 clip fixing nut, 7180085 front changer fork, 7182030 fixing clip, 7182035 inner clip, 7260077 return spring, 7181198 fork fixing axle, 7283049 arm stop plate, 7300114 cable fixing screw washer, 7300117 fixing clip screw washer, 7300138 fixing clip nut washer, 7300159 braze-on front changer washer, 7300161 braze-on front changer concave washer, 7319045 clip pin, 7319055 front arm bolt for braze-on front changer, 7319057 front arm pin for clip-on front changer, 7319058 inner arm pin for braze-on front changer, 7350145 clip-on front changer fixing screw, 7350201 adjusting screw, 7350207 braze-on front changer fixing screw.

Clip-on body **1143067** complete with: 7143382, 7161118, 7182030, 7182035, 7300117, 7319045, 7350145.

Braze-on body **1143068** complete with: 7143383, 7300105, 7319055, 7319058, 7350207.

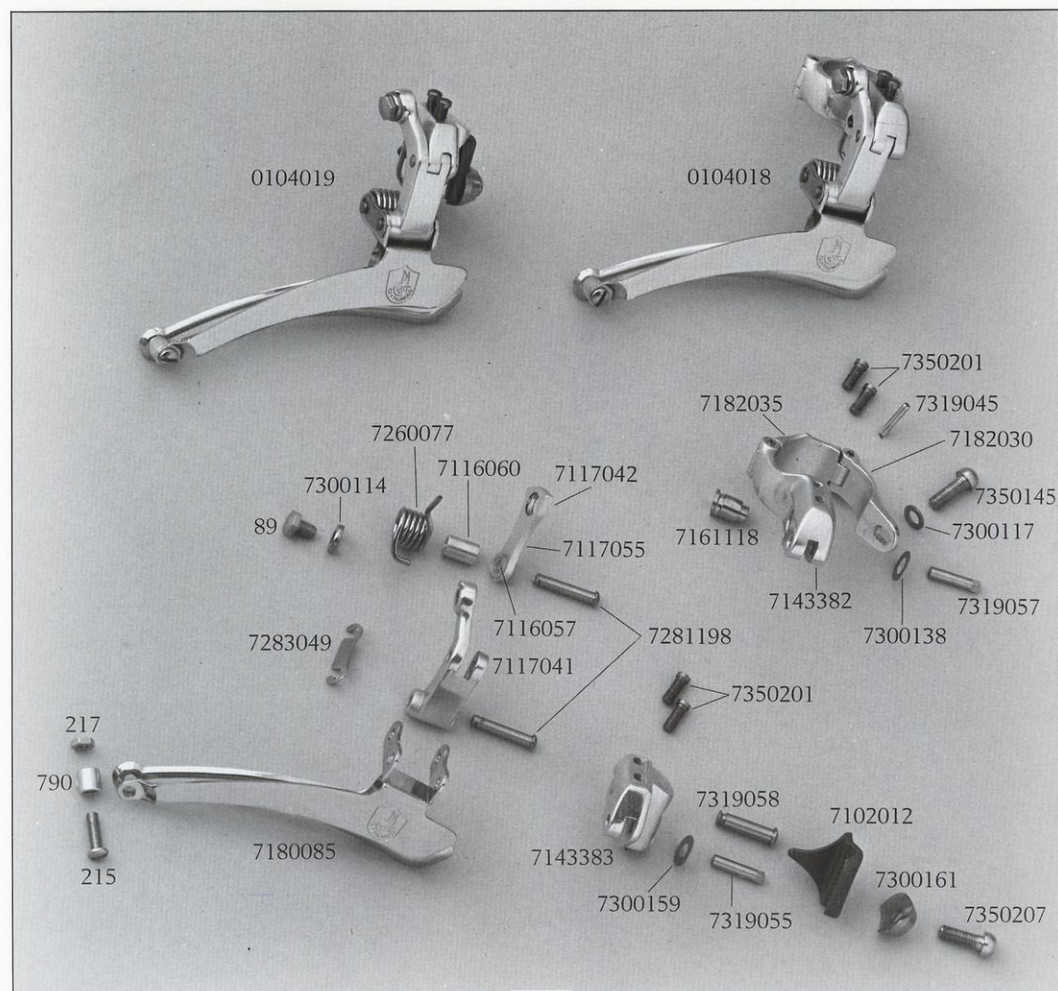

VICTORY® braze-on and clip-on front changer

0104020 and 0104021 composed of:

89 fixing screw, 215 fork cage bolt, 217 nut, 790 bush, 941 circlip, 7102012 braze-on boss, 7117047 front arm, 7117048 inner arm, 7161108 nut, 7182033 inner clip, 7182034 locking clip, 7260073 adjusting screw spring, 7260074 gear return spring, 7300105 convex washer, 7300114 washer, 7350140 adjusting screw.

Fork **1180008** complete with: 215, 217, 790, 7117048, 7180117, 7260074.

Clip-on body **1143064** complete with: 941, 2143021, 7161108, 7182034.

Braze-on body **1143066** complete with: 941, 2143022, 7102012, 7300105, 7161108.

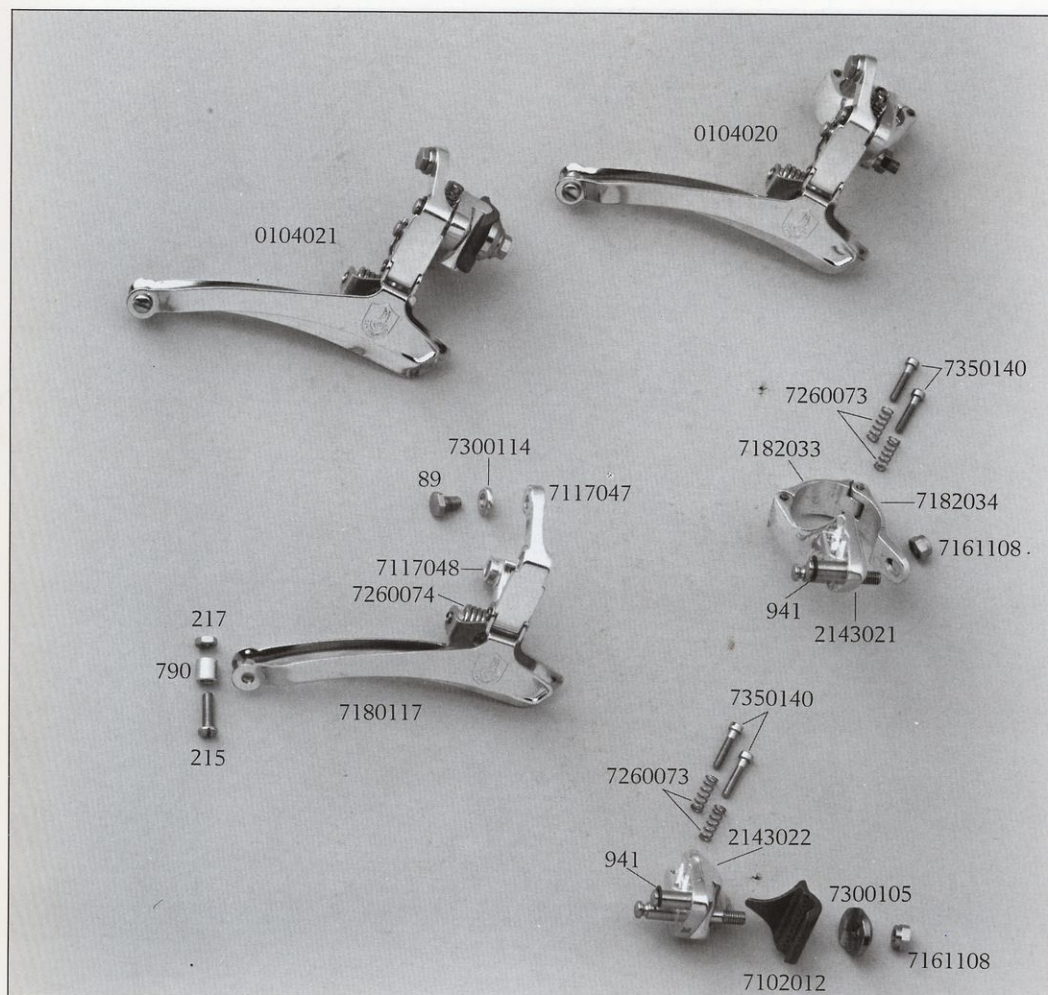

VICTORY® braze-on and clip-on front changer

0104024 and 0104025 composed of:

89 cable fixing screw, 215 fork cage bolt, 217 nut, 790 bush, 941 circlip, 7102012 braze-on boss, 7117047 front arm, 7117048 inner arm, 7161108 nut, 7182033 inner clip, 7182034 locking clip, 7260073 adjusting screw spring, 7260074 return spring, 7300105 convex washer, 7300114 washers, 7350140 adjusting screw.

Fork 1180009 complete with: 215, 217, 790, 7117047, 7117048, 7180099, 7260074.

Clip-on body 1143064 complete with: 941, 2143021, 7161108, 7182033, 7182034.

Braze-on body 1143066 complete with: 941, 2143022, 7102012, 7300105, 7161108.

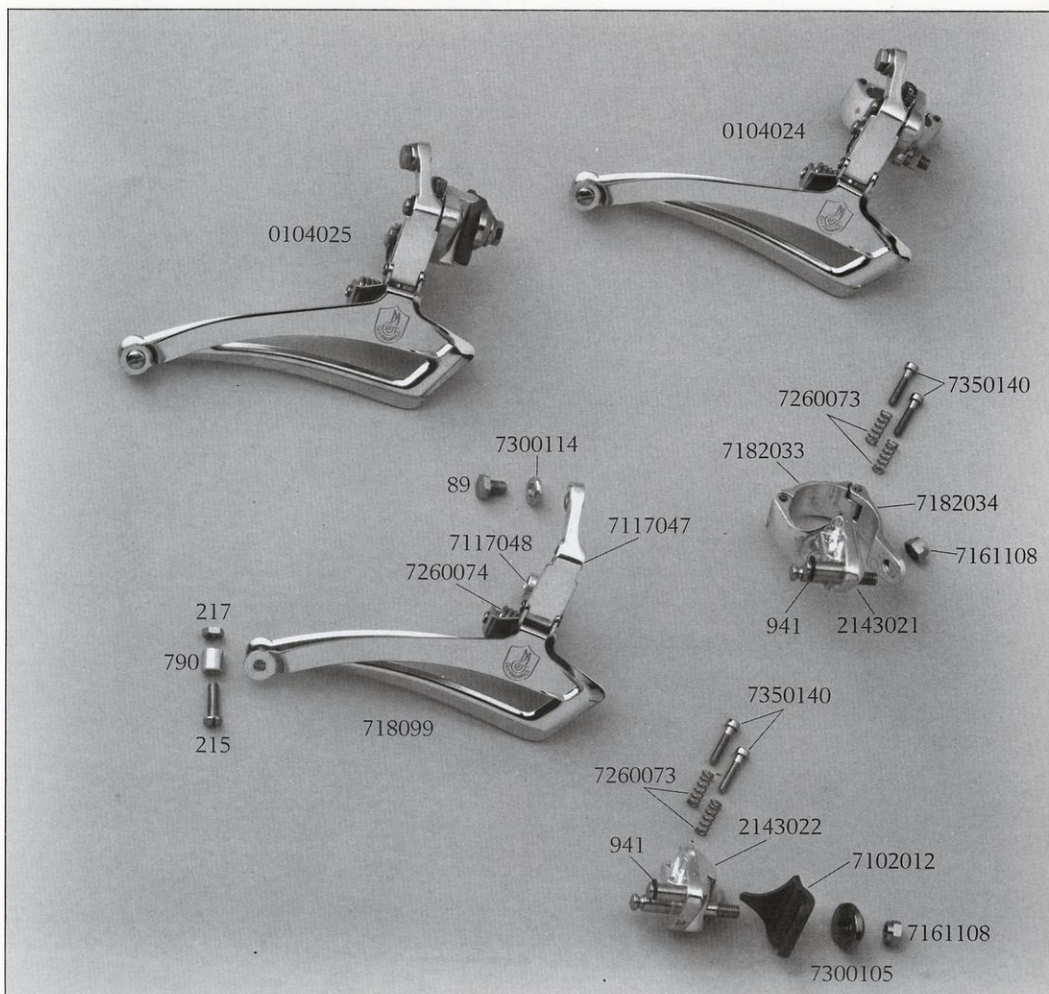

TRIOMPHE® corsa front changer

0104026 composed of:

89 cable fixing screw, 215 fork cage bolt, 217 nut, 790 bush, 941 circlip, 7117047 front arm, 7117048 inner arm, 7161108 nut, 7182039 fixing clip, 7260073 adjusting screw spring, 7260074 return spring, 7300114 washers, 7350140 adjusting spring.

Fork 1180008 complete with: 215, 217, 790, 7117047, 7117048, 7260074, 7180117.

Body 1143065 complete with: 941, 2143031, 7161108, 7182039.

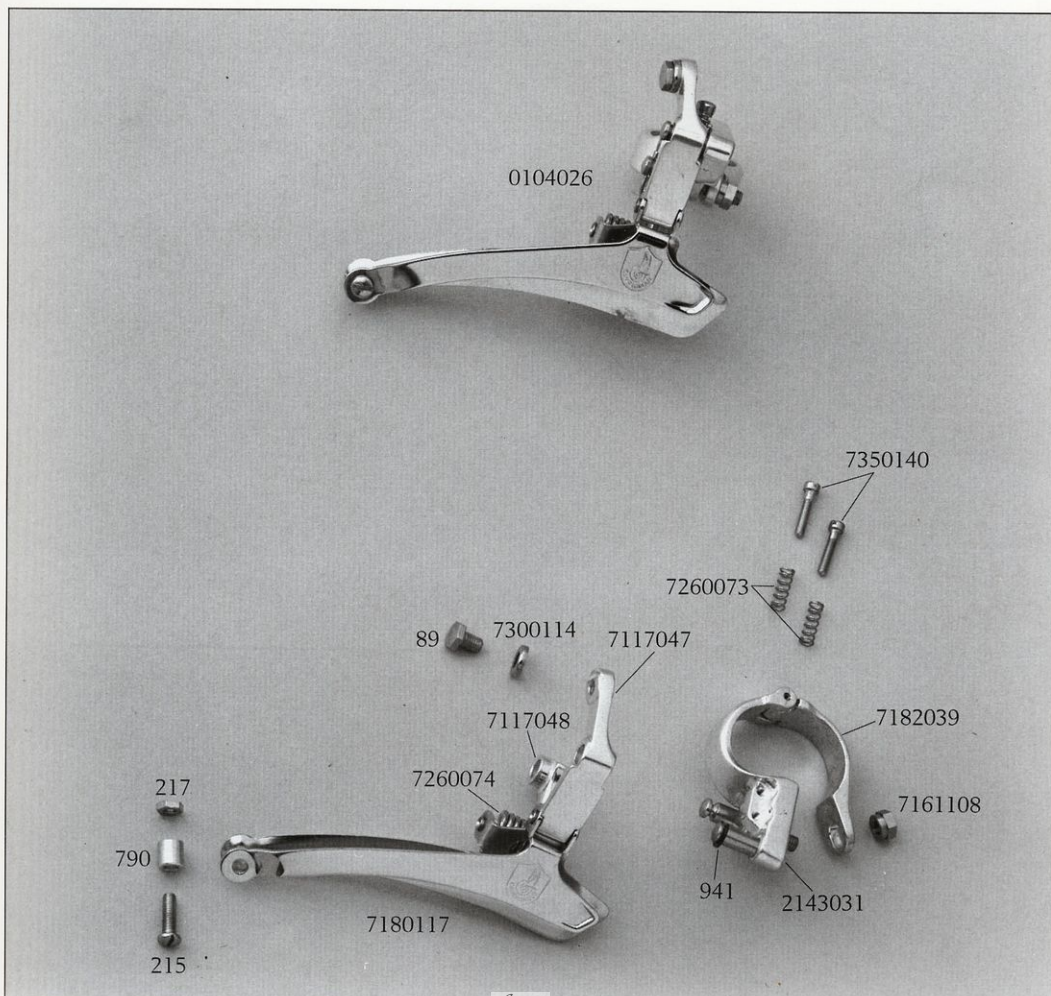

TRIOMPHE® leisure front changer

0104027 composed of:

89 cable fixing screw, 215 fork cage bolt, 217 nut, 790 bush, 941 circlip, 7117047 front arm, 7117048 inner arm, 7161108 nut, 7182039 fixing clip, 7260073 adjusting screw spring, 7260074 return spring, 7300114 washer, 7350140 adjusting screw.

Fork **1180009** complete with: 215, 217, 790, 7117047, 7117048, 7180099, 7260074.

Body **1143065** complete with: 941, 2143031, 7161108, 7182039.

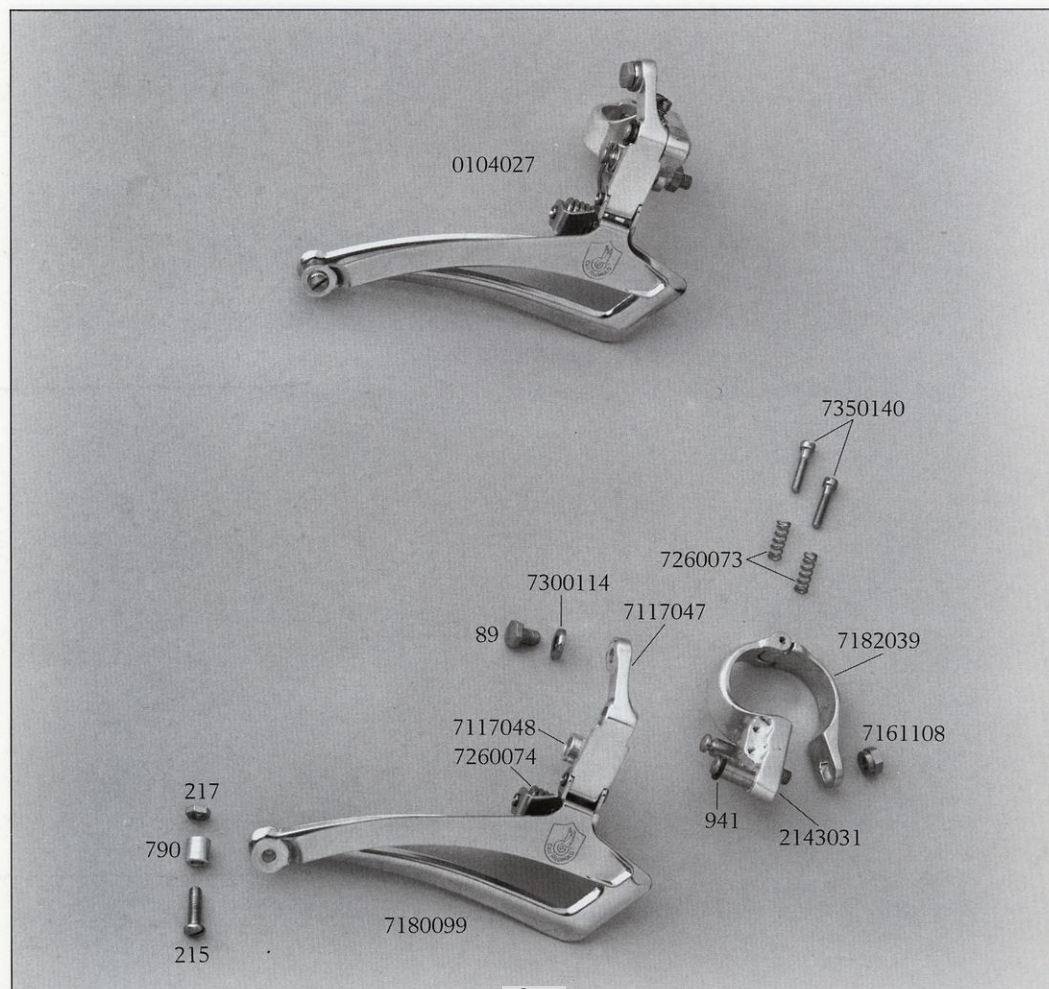

980 Front Changer

0104012 and 0104013 composed of:

89 cable fixing screw, 215 fork cage bolt, 217 nut, 790 bush, 2215/A adjusting spring, 2217 adjusting screw spring, 7117025 upper arm, 7117048 inner arm, 7161108 nut, 7182026 fixing clip, 7260063 return spring, 7300114 cable fixing washer.

Small fork 1180005 complete with: 215, 217, 790, 7117025, 7117048, 7180077, 7260063.

Large fork 1180007 complete with: 215, 217, 790, 7117025, 7117048, 7180099, 7260063.

Body 1143046 complete with: 941, 2143015, 7161108, 7182026.

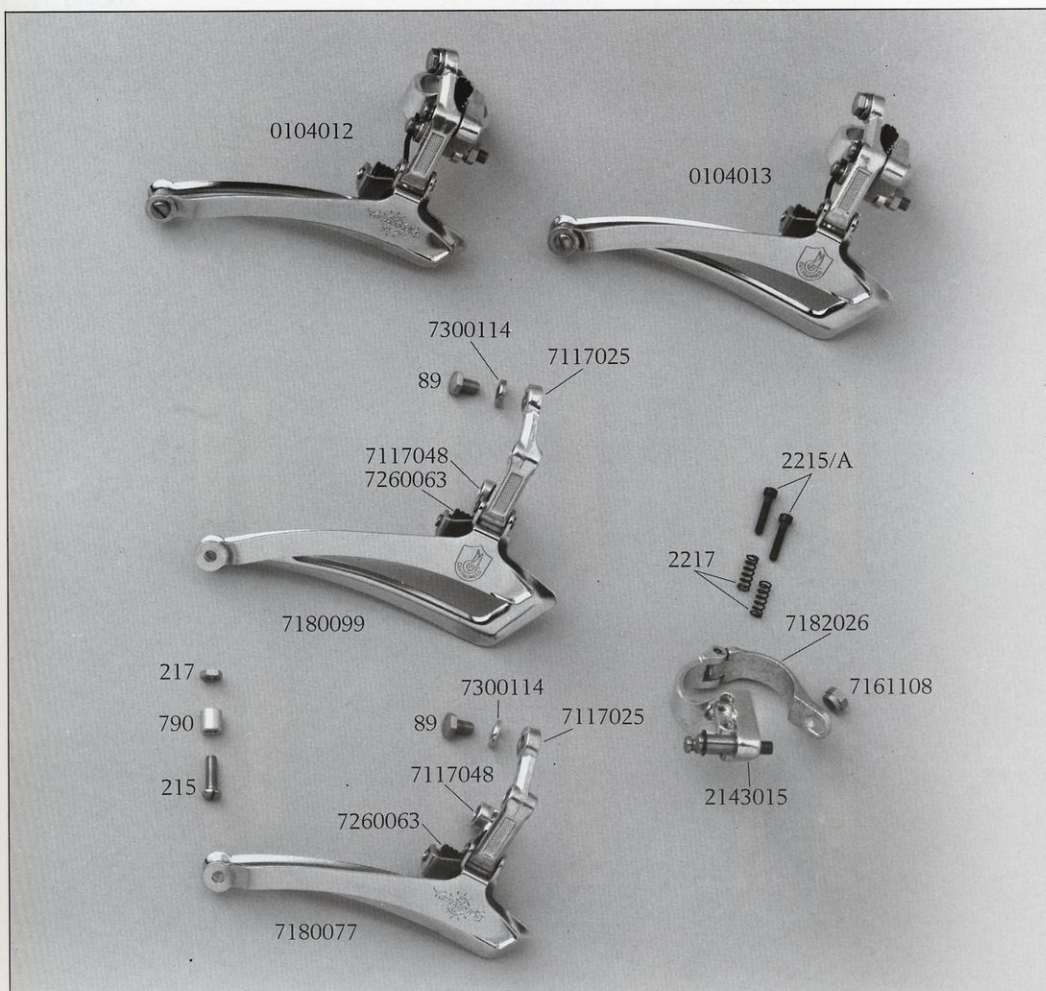

Gear control levers

- 0118071 «C-RECORD» braze-on gear lever, without boss 660
- 0118072 «C-RECORD» braze-on front changer lever, without boss 660
- 0118073 «C-RECORD» braze-on on top of tube lever
- 0118074 «C-RECORD» clip-on lever
- 0118037 «VICTORY» braze-on gear lever, without boss 660
- 0118038 «VICTORY» braze-on front changer lever, without boss 660
- 0118039 «VICTORY» braze-on on top of tube double levers
- 0118060 «VICTORY» clip-on double levers
- 0118042 «TRIOMPHE» braze-on gear lever, without boss 660
- 0118043 «TRIOMPHE» braze-on front changer lever, without boss 660
- 0118061 «TRIOMPHE» clip-on double levers
- 0118063 «TRIOMPHE» braze-on on top of tube double levers

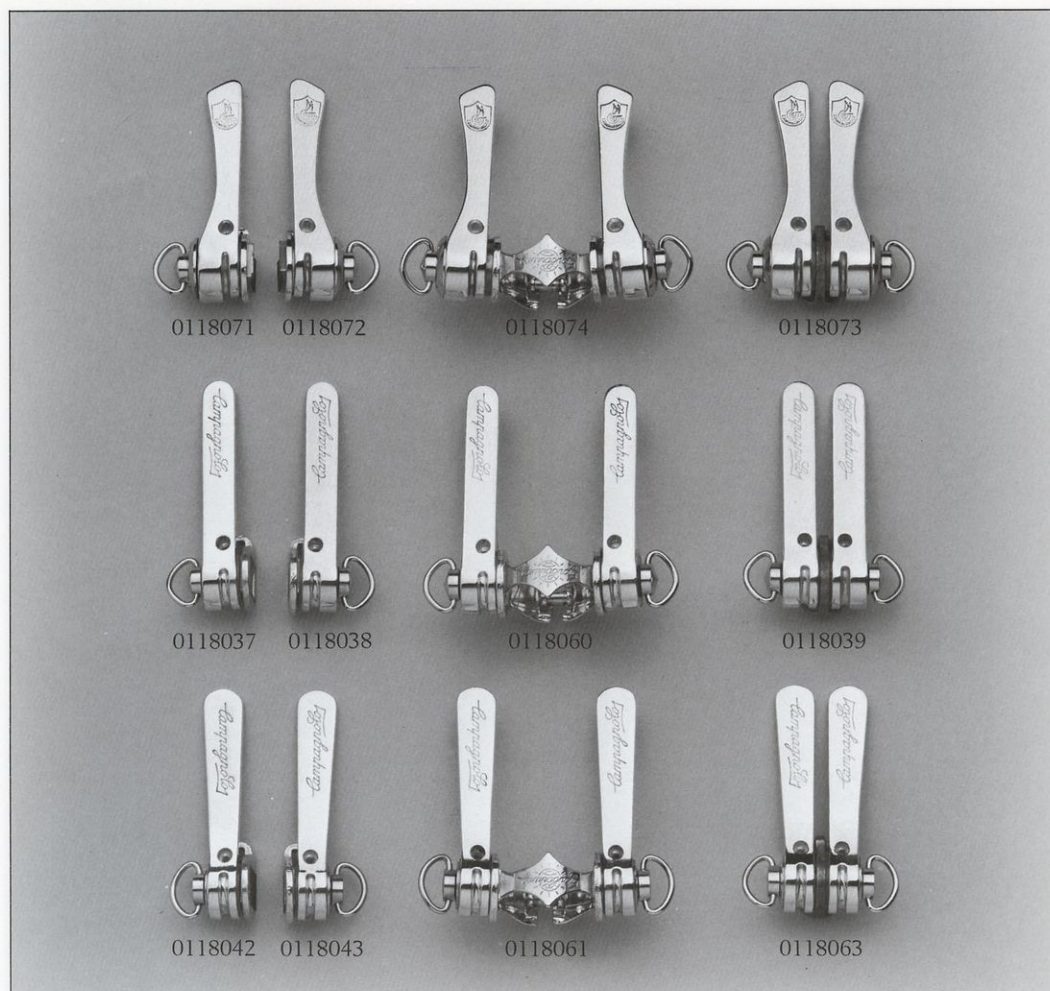

GEAR CONTROL LEVERS components

COMPONENTS	C-RECORD	VICTORY	TRIOMPHE
Gear braze-on control levers*	0118071	0118037	0118042
Front changer braze-on control levers*	0118072	0118038	0118043
Adjusting wing nut	1202005	1202004	1202003
Outer friction washers	7306005	0190/06	0190/06
R.H. lever	1264041	7264018	7264020
L.H. lever	1264015	7264019	7264021
Inner friction washer	7306004	0190/04	0190/04
R.H. bracket	7320031	7320025	7320025
L.H. bracket	7320032	7320026	7320026
Braze-on boss	660	660	660
Clip-on twin control levers*	0118074	0118060	0118061
Adjusting wing nut	604/1	1202004	1202003
Outer friction washers	7306005	0190/06	0190/06
R.H. lever	1264014	7264018	7264020
L.H. lever	1264015	7264019	7264021
Inner friction washer	7306004	—	—
Clip fixing nut	777	777	777
Clip fixing screw	609/1	609/1	609/1
Twin control lever clip	1182021	1182021	1182021
Braze-on on top tube levers*	0118073	0118039	0118063
Adjusting wing nut	604/1	1202004	1202003
Outer friction washers	7306005	0190/06	0190/06
R.H. lever	1264014	7264018	7264020
L.H. lever	1264015	7264019	7264021
Washer	7300152	—	—
Inner friction lever	7306004	0190/04	0190/04
On top of tube braze-on boss	7316014	7316014	7316014
COMMON PARTS			
Convex washer	—	—	7304005
Washers	—	—	7320115
Disc spring	—	0190/07	—
Cover	7136040	7136030	—
Cup spring	7260086	—	—
Bush	7325002	—	—

Remark: In the packages are not included the b/o bosses 660 and 7316014 must ber ordered separately.

* See also COMMON PARTS.

HUBS sets

- 322/101 «C-RECORD» s.f. hubs sets with original q.r. (24-28-32-36-40 holes)
 321/101 «C-RECORD» l.f. hubs sets with original q.r. (24-28-32-36-40 holes)
 322/102 «C-RECORD» s.f. solid spindle track hubs sets (24-28-32-36-40 holes)
 321/102 «C-RECORD» l.f. solid spindle track hubs sets (24-28-32-36-40 holes)
 422/000 «VICTORY» s.f. hubs sets with original q.r. (32-36 holes)
 421/000 «VICTORY» l.f. hubs sets with original q.r. (32-36 holes)
 922/000 «TRIOMPHE» s.f. hubs sets with original q.r. (36 holes)
 921/000 «TRIOMPHE» l.f. hubs sets with original q.r. (36 holes)

Remark: If not specified the hubs will be supplied: 36 holes, Italia thread, 6 speed.



HUBS Components

COMPONENTS	C-RECORD corsa	C-RECORD track	VICTORY	TRIOMPHE
Front hub cup	7131071	7131071	1270	1270
Front dust cover	7146011	7146011	7146012	7146012
Front axle	19	19/P	420/003	420/003
Front cone	7133051	7133051	7133052	7133052
Front washer	320/001	320/001	420/001	420/001
Front locking	7161128	7161128	1	1
3/16" front ball sets (9+9)	2105	2104	2104	2104
Circlip for front dust cover	7100033	7100033	—	—
Central clip	7182028	7182028	—	—
Rear hub cup	7131072	7131072	1271	1271
Rear dust cover	7146015	7146015	7146013	7146013
L.H. rear dust cover	7146014	7146017	—	—
Rear axle	29/R	29/P	420/004	420/004
Rear cone	7133053	7133053	7133053	7133053
Rear teathed washer	320/002	320/002	420/002	420/002
Rear locking	7161129	1283	1283	1283
1/4" rear ball sets (9+9)	2106	2106	2106	2106
Circlip for rear dust cover	7100034	7100034	—	—
Front fixing screw	—	667	—	—
Rear fixing screw	—	668	—	—
Spacers	46	—	46	46
Lockring	—	743	—	—

Remark: For the extraction of the dust covers from the C-RECORD corsa and track hubs it is necessary to use the EXTRACTOR 1170004 to be ordered separately.

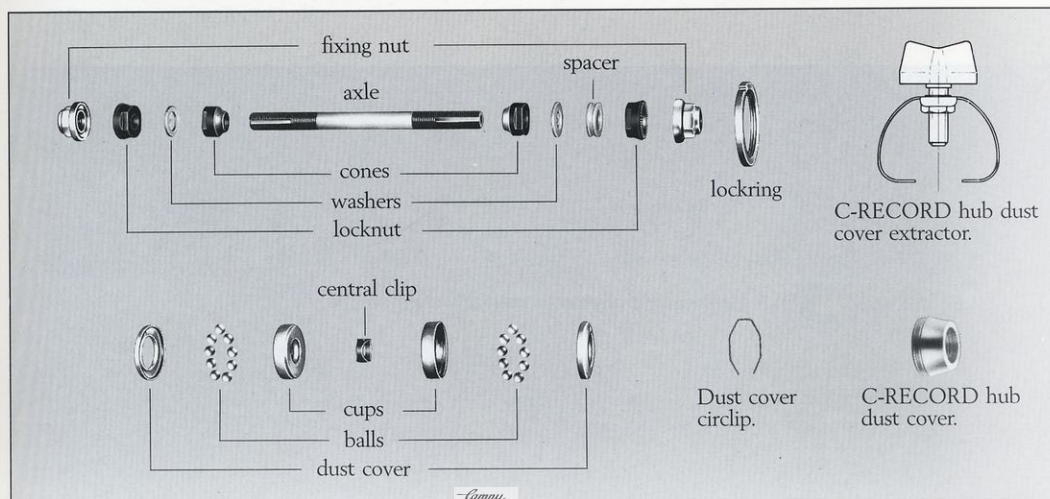

QUICK RELEASE Components

314/101 «C-RECORD» complete front quick release
 314/102 «C-RECORD» complete rear quick release
 414/101 «VICTORY» complete front quick release
 414/102 «VICTORY» complete rear quick release
 914/101 «TRIOMPHE» complete front quick release
 914/102 «TRIOMPHE» complete rear quick release

COMPONENTS	C-RECORD	VICTORY	TRIOMPHE
Cap	7142008	7142009	7142010
Tension spring	1304	1304	1304
Lever	7264026	7264027	7264027
Q.r. pivot	7281199	—	—
Front skewer	314/001	1305	1305
Rear skewer	314/002	1306	1306
Adjusting nut	2202003	2161006	7161141
Spring	—	1309	1309
Conical spring	18	18	18
Circlip	—	7100040	7100040

Remark: The quick releases and relevant skewers are available in the versions: five, six, seven speed. If not specifies the six speed version will be supplied.

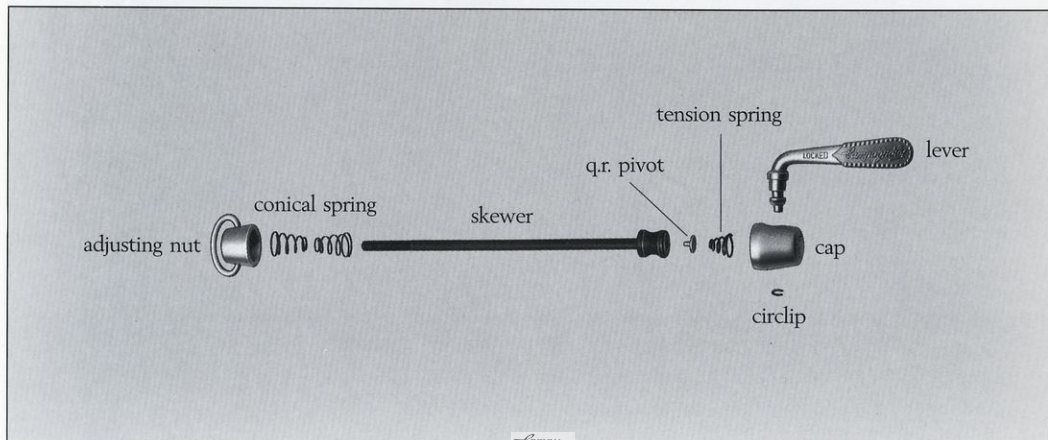

HEAD Sets

304/104 «C-RECORD» corsa and track head set
 404/000 «VICTORY» corsa and leisure head set
 904/000 «TRIOMPHE» corsa and leisure head set

COMPONENTS	C-RECORD	VICTORY	TRIOMPHE
Locknut	304/003	681	681
Teethed washers	7300119	682	682
Upper cup	304/004	404/001	904/001
Upper cone	7133045	684	684
Lower cup	1131038	685	7131084
Lower cone	7133046	686	7133063
Set ball races	1134014	2101	2101

Remark: Each model is available with Italian, French, Bsa thread. If not specified Italian thread will be supplied.

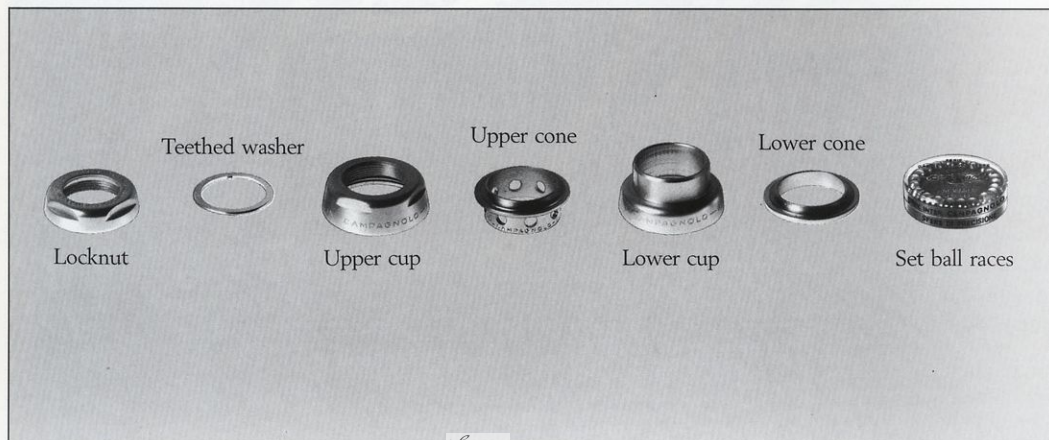

CHAINWHEEL components

- 0355 «VICTORY» corsa and leisure chainwheel set, 116 mm w, 170 mm long crank, pedal hole \varnothing 9/16"x20F. and 1/2x3/32" (2 mm) chainrings, available in 35, 36, 37, 38, 39, 40, 41, 42, 43, 50, 51, 52, 53, teeth.
- 0365 «TRIOMPHE» corsa and leisure chainwheel set, 116 mm w, 170 mm long crank, pedal hole \varnothing 9/16"x20F. and 1/2x 3/32" (2 mm) chainrings, available in 35, 36, 37, 38, 39, 40, 41, 42, 50, 51, 52, 53 teeth.
- 306/101 «C-RECORD» corsa chainwheel set, 135 mm w, 170 mm long crank, pedal hole \varnothing 9/16"x20F. and 1/2x3/32" (2 mm) chainring. Specify number of rings available from 39 to 57 teeth. Upon request cranks 165, 167.5, 172.5, 175, 180 mm long are supplied.
- 306/102 «C-RECORD» track chainwheel set, 144 mm w, 170 mm long crank, pedal hole \varnothing 9/16"x20F. and 1/2x1/8" chainrings (3 mm). Specify number of rings available from 42 to 56 teeth. Upon request cranks 165, 167.5, 172.5, 175, 177.5, 180 mm long and rings 1/2x1/8" (2 mm) are supplied.

CHAINWHEEL COMPONENT	CHAINWHEEL	CRANK	CRANK	CRANK
0355	116	170	170	170
0365	116	170	170	170
306/101	135	170	170	170
306/102	144	170	170	170
0355	116	170	170	170
0365	116	170	170	170
306/101	135	170	170	170
306/102	144	170	170	170

Legend of the bicycle model numbers: 116 = 116 mm chainwheel width, 170 = 170 mm crank length, 170 = 170 mm crank length.

Remark: The chainrings and cranks are available in the following sizes: 165, 167.5, 172.5, 175, 177.5, 180 mm. If not specified, the 172.5 mm version will be supplied.



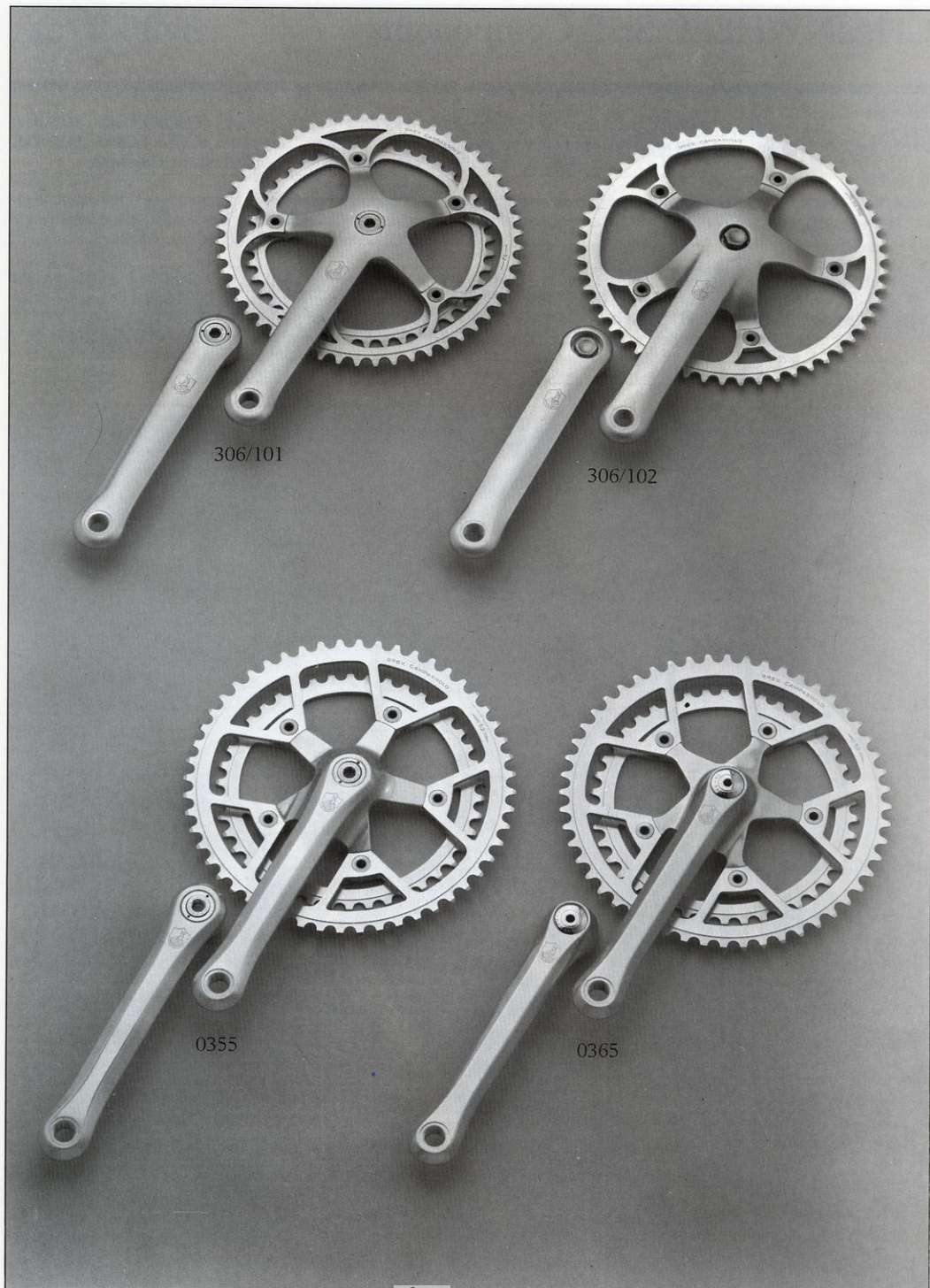

CHAINWHEEL SET Components

306/051 «C-RECORD» corsa chainring 1/2x3/32" (2 mm)

760/A «C-RECORD» track chainring 1/2x1/8" (3 mm)

3327/GS «VICTORY» and «TRIOMPHE» 1/2x3/32" (2 mm)

number of teeth of chainrings	chainrings in mm			
	C-RECORD Corsa	C-RECORD Track	VICTORY	TRIOMPHE
35	—	—	116	116
36	—	—	116	116
37	—	—	116	116
38	—	—	116	116
39	135	—	116	116
40	135	—	116	116
41	135	—	116	116
42	135	144	116	116
43	135	144	116	116
44	135	144	—	—
45	135	144	—	—
46	135	144	—	—
47	135	144	—	—
48	135	144	—	—
49	135	144	—	—
50	135	144	116	116
51	135	144	116	116
52	135	144	116	116
53	135	144	116	116
54	135	144	—	—
55	135	144	—	—
56	135	144	—	—
57	135	—	—	—

CRANKS	C-RECORD Corsa	C-RECORD Track	VICTORY	TRIOMPHE
Right hand crank	306/001	306/003	406/001	906/001
Left hand crank	306/002	306/004	406/002	906/002
CRANKS LENGTH in mm	C-RECORD Corsa	C-RECORD Track	VICTORY	TRIOMPHE
165	●	●		
167,5	●	●		
170	●	●	●	●
172,5	●	●		
175	●	●		
177,5	●	●		
180	●	●		
COMPONENTS	C-RECORD Corsa	C-RECORD Track	VICTORY	TRIOMPHE
Chainrings fix. screw	754	761	754	754
Chainring fix. nut	755	762	755	755
Screw with incorporated extractor	2350001	—	2350001	—
Washer	7300116	—	7300116	—
Cover	—	756	—	756

Remark: For the C-RECORD ranges specify the crank length. If not specified the standard version 170 mm long will be supplied.

SEAT PINS

316/101 «C-RECORD» corsa and track with one fixing screw, 180 mm long, **styled** seat pin.

316/102 «C-RECORD» corsa and track with one fixing screw, 130 mm long, **circular** seat pin.

Available in the following diametres: 25, 25.8, 26, 26.2, 26.4, 26.6, 26.8, 27, 27.2.

416/000 «VICTORY» and «TRIOMPHE» corsa and leisure, with one fixing screw, 180 mm long **styled** seat pin.

416/101 «VICTORY» and «TRIOMPHE» corsa and leisure, with one fixing screw, 130 mm long, **circular** seat pin.

Available in the following diametres: 25, 26.2, 26.4, 26.8, 27, 27.2.

Components: 1160/02 «C-RECORD» seat pin support, 1160/03 «C-RECORD» seat pin bracket, 7300122 «VICTORY» and «TRIOMPHE» seat pin convex washer, 7300129 «C-RECORD» seat pin convex washers, 7316013 «VICTORY» and «TRIOMPHE» seat pin support, 7320024 «VICTORY» and «TRIOMPHE» seat pin bracket, 7350152 «VICTORY» and «TRIOMPHE» seat pin screw, 7350162 «C-RECORD» seat pin screw.



BOTTOM BRACKET Sets

303/101 «C-RECORD» road bottom bracket set with braze-on boss

303/102 «C-RECORD» track bottom bracket set with braze-on boss, with screws and washers

403/100 «VICTORY» bottom bracket set with braze-on boss

903/100 «TRIOMPHE» bottom bracket set with braze-on boss, with screws and washers

3331 «GRAN SPORT» bottom bracket set with braze-on boss, with screws and washers (to convert the «VICTORY» and «TRIOMPHE» chainwheels into triple chainring)

Meaning of the «Axle initials»

- the first number indicates the bracket width
- the letters SS indicate road
- the letters SP indicate road and track (equal sizes)

Upon request the set of the cups and locking with thread increased by 0,5 mm is supplied.

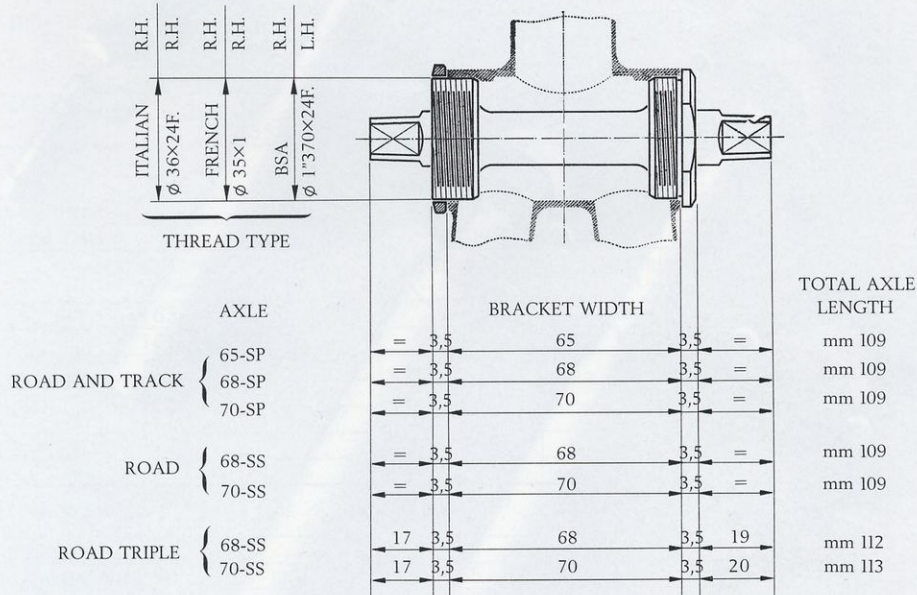

BOTTOM BRACKET Components

COMPONENTS	C-RECORD ROAD	C-RECORD TRACK	VICTORY corsa/leisure	TRIOMPHE corsa/leisure	GRAN SPORT
R.H. cup	4033	4033	745	903001	745
L.H. cup	4034	4034	746	903002	746
Axle	303001	303001	403001	903003	3332
Lockring	747	747	747	747	747
Ball races	4035/A	4035/A	2100	2100	2100
Cone for sleeve	2110/1	—	—	—	—
Sleeve	2110	—	—	—	—
Washer	—	7300160	—	749	749
Screw	—	7350204	—	748	748

Remark: Each model is available with Italian, French and Bsa thread. If not specified Italian thread will be supplied.

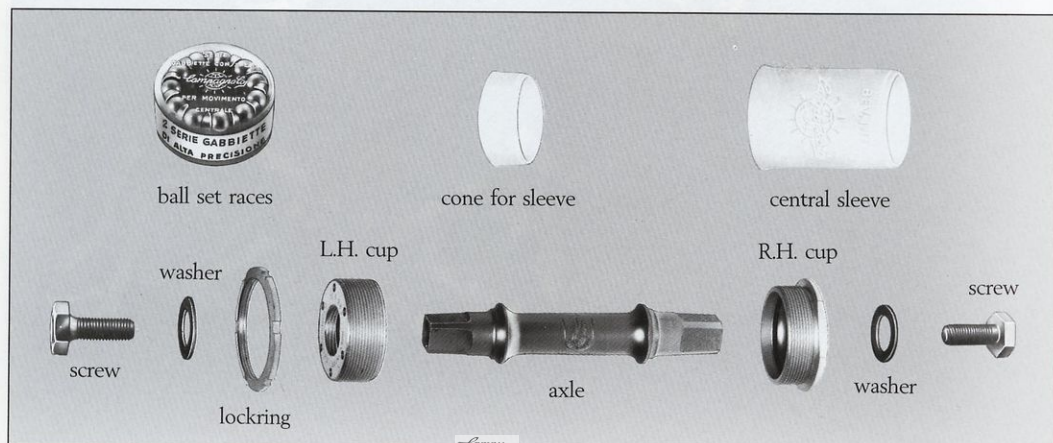

PEDALS sets

305/501 «C-RECORD» corsa and track pedals set
 405/000 «VICTORY» corsa and leisure pedals set
 905/000 «TRIOMPHE» corsa and leisure pedals set

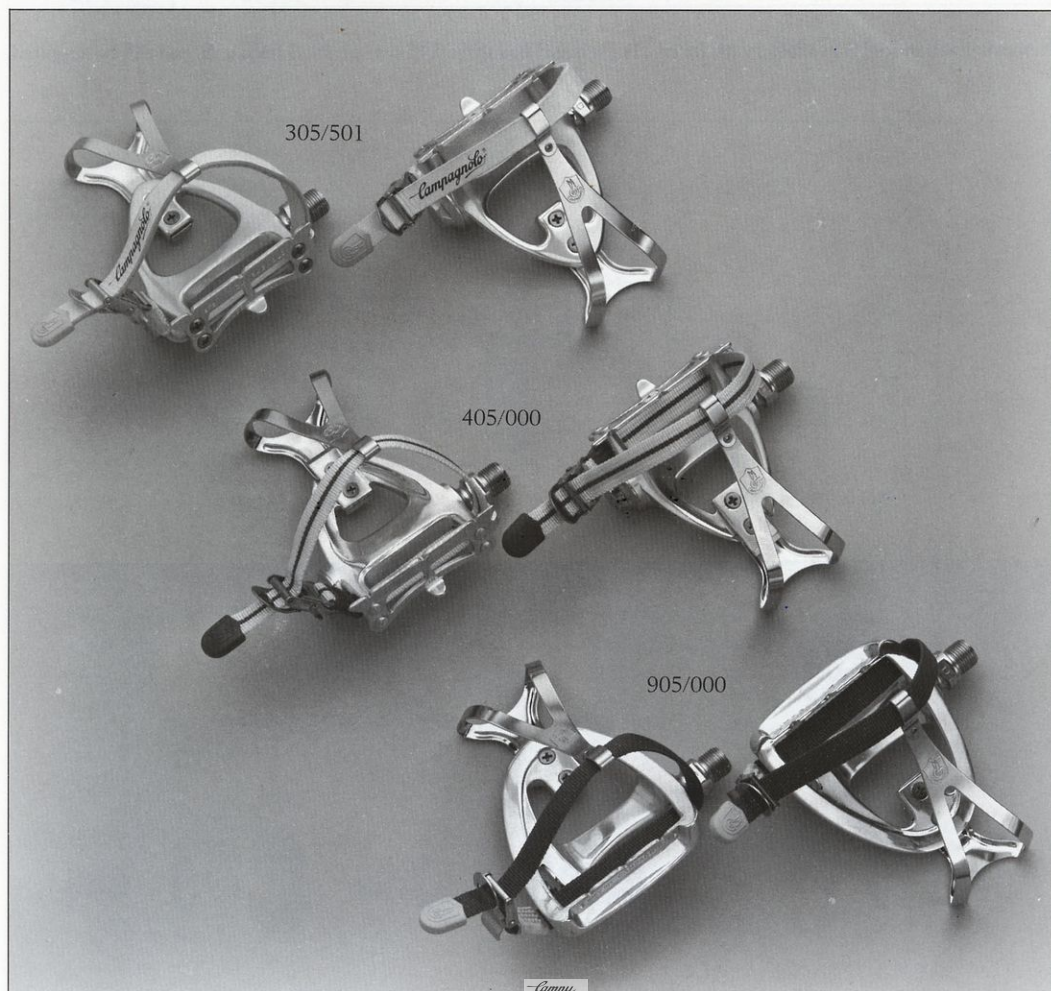

PEDALS Components

COMPONENTS	C-RECORD	VICTORY	TRIOMPHE
Cup	672	7131053	7131053
Dust cover	678	678	678
Cone	674	674	674
Teethed washer	673	673	673
Locknut	675	675	675
R.H. pedal axle	670	7281066	7281066
L.H. pedal axle	669	7281067	7281067
(48) \varnothing 5/32" Ball set	2103	2103	2103
Pedal cap	7136031	7136029	7136029
R.H. pedal plate	7283031	—	—
L.H. pedal plate	7283032	—	—
Medium toe-clip	1183015	1183011	1183011
Long toe-clip	1183016	1183012	1183012
Toe-clip plate	7283043	7283044	7283045
Toe-clip fixing screw	7350149	7350149	7350149
Nut	—	217	—
Plate fixing screws	7350148	—	—
Strap	2153003	2153001	2153002
Strap retainer	7188006	7188004	7188005
Retainer fixing screws	7350178	7350178	7350178

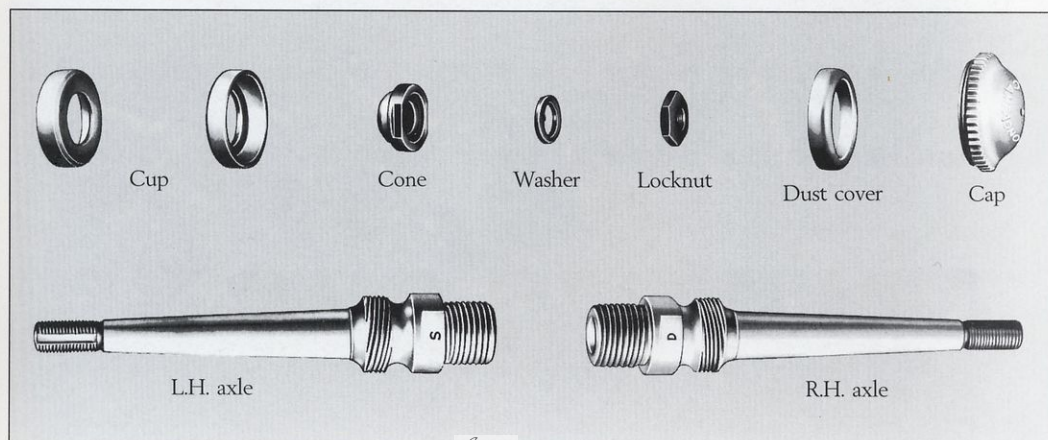

BRAKES Components

315/101 «C-RECORD» brakes set with levers, cable and casing - adjusting stroke 40,5 mm and 56,5 mm.

415/000 «VICTORY» brakes set with levers, cables and casings - adjusting stroke 47 mm.

915/101 «TRIOMPHE» brakes set with levers and cables - adjusting stroke 47 mm and 52 mm.

Remark: VICTORY and TRIOMPHE are available in the normal and allen bolt versions. If not specified allen bolt, 47 mm version will be supplied.

315/101



415/000



915/000

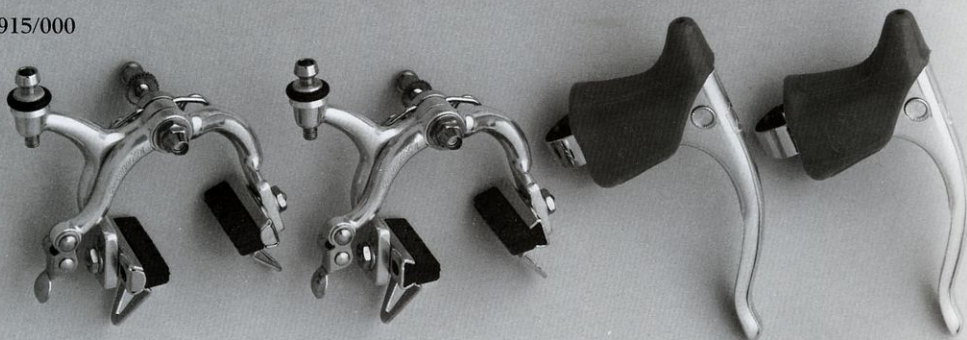

RECORD brakes components

0116070, 0116071, 0118065 composed of:

0120059 complete front cable and casing, 0120060 complete rear cable and casing, 315/001 cover, 2015/1 washers, 2028 front cable, 2029 rear cable, 2034 lever pivot pin, 2035 pivot pin, 2036 grub screw, 2037 nut fixing clip, 2038 bush, 2041 toothed washer, 1116001 cam bush, 1116002 end cap bush, 1201013 front casing, 1201014 rear casing, 2200001 cable grub, 3210001 wheelguide, 7100035 arm stop axle ring, 7100036 cable pivot stop ring, 7117053 upper arm, 7117054 lower arm, 7136046 rubber, 7143693 brake body, 7143714 lever brake body, 7160072 spacer, 7161105 allen brake fixing bolt, 7161121 brake shoe fixing nut, 7161138 lever fixing screws locknut, 7182031 brake lever fixing clip, 7200014 cover fixing grub, 7201032 brake lever hood, 7203040 adjusting sleeve, 7241047 r.h. brake shoe lever, 7241048 l.h. brake shoe, 7241050 brake lever, 7260079 r.h. spring, 7260080 r.h. spring, 7281184 arm connecting pivot, 7281185 cable locking nut, 7281187 guide cable pivot, 7283046 guide cable plate, 7289003 brake block, 7290014 brake shoes, 7300071 washer, 7300141 washer, 7300142 concave washer, 7300143 washer, 7300144 spacer, 7350168 front brake axle, 7350169 rear brake axle, 7350170 brake levers fixing screws, 7350171 brake shoes fixing screws, 7350176 lever fixing screws, 1284013 complete arm mechanism.

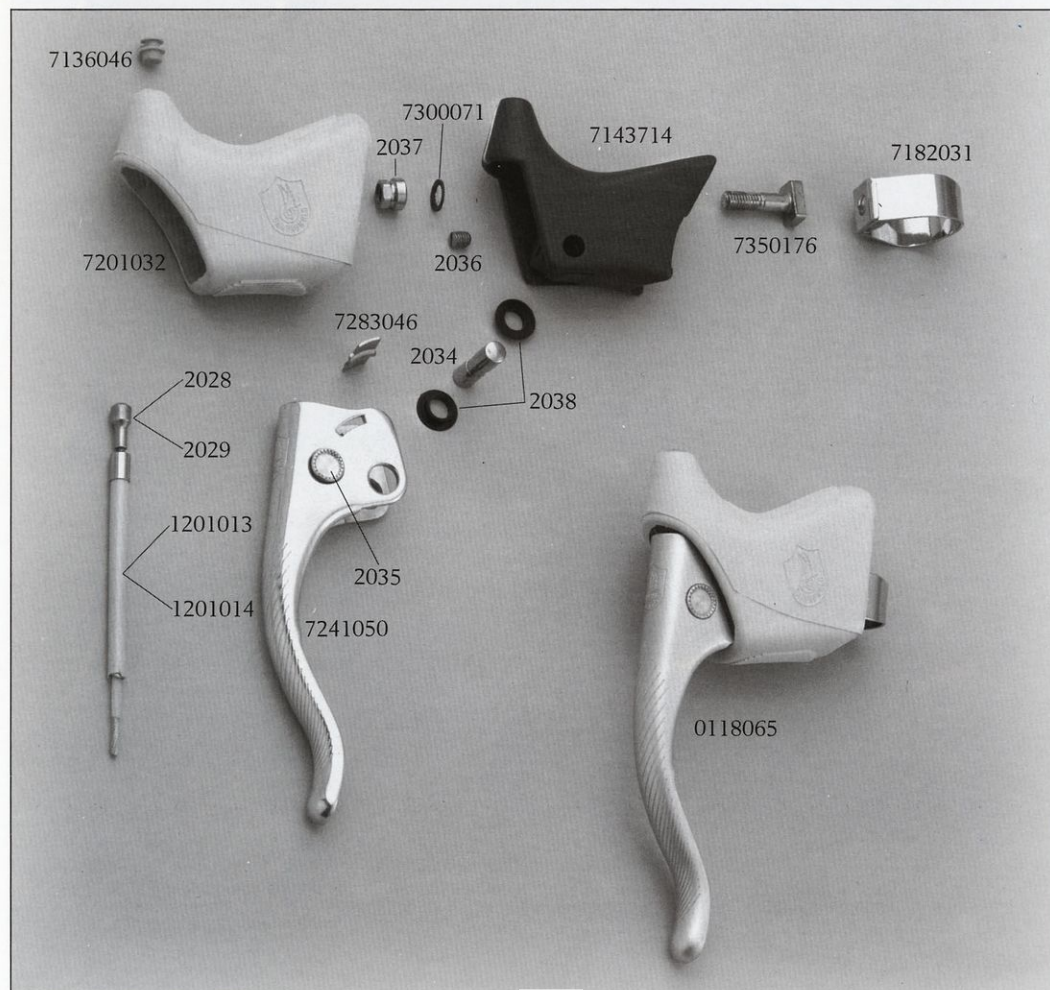



VICTORY® and TRIOMPHE® brake components

415/001 «VICTORY» brake set, normal version, small 47 mm
 415/102 «VICTORY» brake set, allen bolt version, small 47 mm
 915/101 «TRIOMPHE» brake set, normal version, small 47 mm
 915/102 «TRIOMPHE» brake set, normal version, large 52 mm
 915/201 «TRIOMPHE» brake set, allen bolt version, small 47 mm
 915/202 «TRIOMPHE» brake set, allen bolt version large 52 mm
 0118065 «C-RECORD» complete brake lever
 0118059 «VICTORY» complete brake lever
 0118066 «TRIOMPHE» complete brake lever

REF.	COMPONENTS	VICTORY	TRIOMPHE
1	Self locking nut	2002/AB	2002/AB
2	Allen bolt	7161105	7161105
3	Washer	2003	2003
4	Toothed washer	2041	2041
5	Normal front axle	7281143	7281143
5	Front allen axle and rear normal axle	7281144	7281144
6	Adjusting screw	2009	2009
7	Adjusting nut	7161139	7161139
8	Adjusting nut rubber	7208011	2024
9	Rear large brake shoe lever	—	7241061
10	Front large brake shoe lever	—	1241022
11	Rear normal axle and front allen axle	7281144	7281144
11	Rear allen axle	7281146	7281146
12	Sliding washer	2015	2015
13	Spring	2011	2011
14	Rear small brake shoe lever	7241040	7241060
15	Inner sliding washer	2015/1	2015/1
16	Front small brake shoe lever	1241021	1241023
17	Brake shoe fixing lever washer	7300145	7300145
18	Brake shoe fixing lever nut	7161140	7161140
19	Brake shoe fixing lever locknut	7161120	7161142
20	Cable clamp washer	2004	2004
21	Cable clamp washer	2008	2008
22	Block	7289004	2010
23	Brake block fixing nut	7161126	7161126
24	R.H. brake shoe	7290009	7290009
25	L.H. brake shoe	7290010	7290010
26	Brake lever hood	7201031	2039
27	Clip fixing nut	2037	2037
28	Retainer grub	2036	2036
29	Brake lever support	7143394	7143394
30	Clip fixing screw	7350177	7350177
31	Brake lever fixing clip	7182031	7182031
32	Brake lever bush	2038	2038
33	Lever pivot pin	2034	2034
34	Brake lever	—	7241054
35	Front brake cable	2028	2028
36	Front brake casing	2026	—
37	Brake lever	7241053	—
38	Rear brake cable	2029	2029
39	Rear brake casing	2027	—

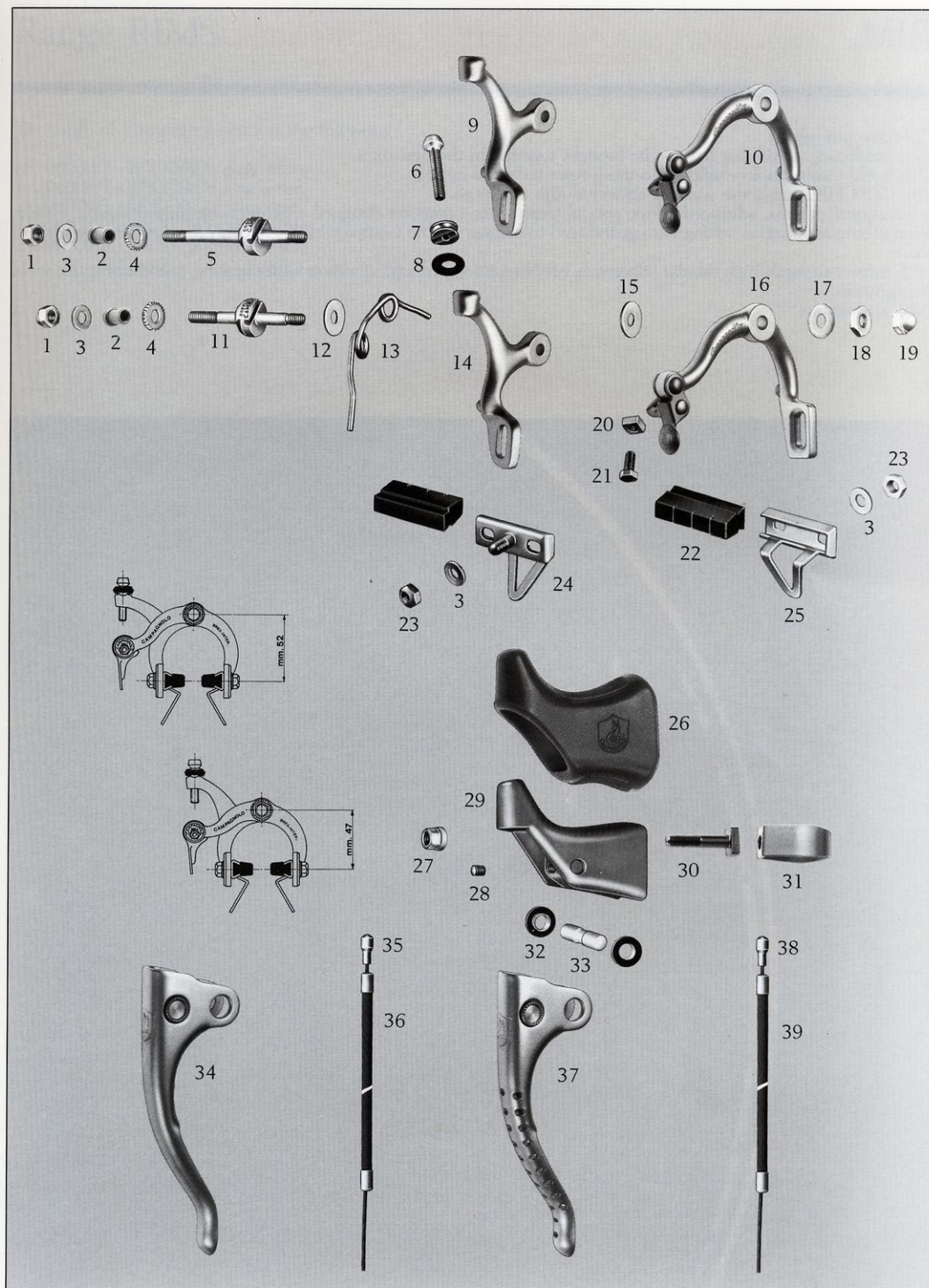

RIM

Elasticity and rigidity.

Two conflicting needs that have to be brought together in the best rims.

This is the Campagnolo challenge to the former technical limits.

The CERCHIO rim is the winning answer to this challenge.

International patents, advanced alloys, special treatments, computer-designed cross-sections, angled double eyelets, micrometric anodisation setting with guaranteed tolerances: all the Campagnolo technology for a perfect geometrical shape.

High impact strength, high tubular adherence, easy mounting, reduced vibration under braking, minimum spoke wear.

All lightness.

All Campagnolo.

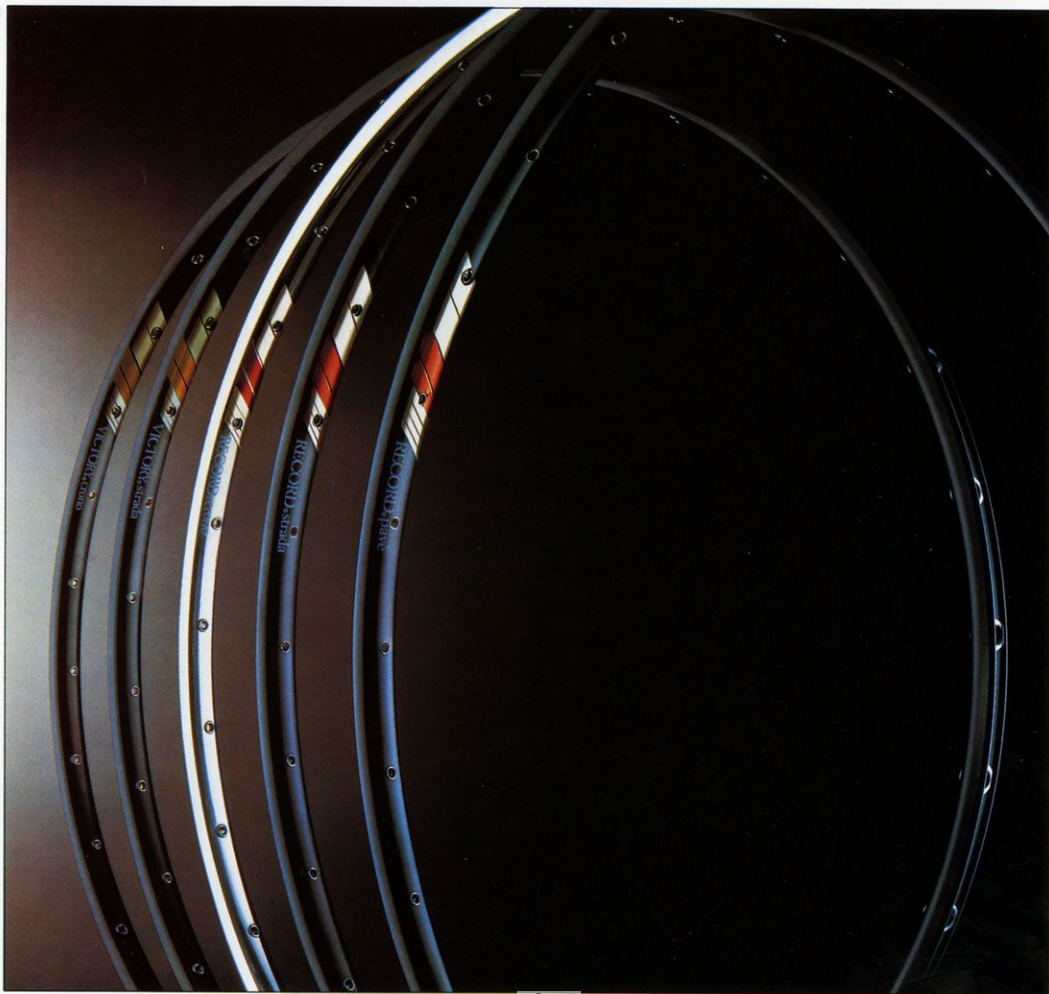

Range RIMS

The range of Campagnolo rims is the following:

- art. 060.101 «RECORD» pavé rim
- art. 060.102 «RECORD» strada rim
- art. 060.103 «RECORD» crono rim
- art. 060.104 «VICTORY» strada rim
- art. 060.105 «VICTORY» crono rim

FEATURES					
TYPE	RECORD			VICTORY	
USE TO BE MADE	PAVÉ	STRADA	CRONO	STRADA	CRONO
CATALOGUE	060.101	060.102	060.103	060.104	060.105
SIZE	700 C	700 C	700 C	700 C	700 C
WIDTH	22 mm	22 mm	20 mm	20 mm	20 mm
WEIGHT	365 g	330 g	280 g	310 g	285 g
THICKNESS TOLERANCE	± 3/100 mm	± 3/100 mm	± 3/100 mm	± 3/100 mm	± 3/100 mm
HEAT TREATMENT	YES	YES	YES	YES	YES
FINISHING	hard anodizing		silver	hard anodizing	
DRILLING	N°. 24 - 28 - 32 - 36 - 40 holes			N°. 32 - 36 * holes	
EYELETS	double positioned				

* other drilling upon request.

Technology and performances

The rims of Campagnolo range are characterized by a different profile, by a different weight, by a different heat treatment. All the rims have the same high quality degree and the maximum technology. The level of performances changes according to the different use which has to be made with the rims.

Profile:

For tubular tyre. Obtained from an alloy rolled section, brazed and shaped according to computer drawing to guarantee the maximum ratio between the radial elasticity and the transversal stiffness according to the performances (**maximum stoutness and comfort**).

Tolerance of the rolled section thickness 3/100 mm (**better balancing**).

Bending of the sides designed for the perfect centering of the brake blocks (**reduction of braking vibrations**).

Very high elastic limit (**indeformability - ease of centering**).

Shaping of the tubular tyre seat for its best seal to the side-thrusts (**seal in curve**).

Special connectors of the shaping to protect the safety of the tubular tyre (**less wear of same**).

Joint:

Inner coupling precision with tolerance $\pm 1/100$ mm (**guarantee of superficial continuity**).

Alloy:

The most advanced Al-Zn alloy present for heat treatments (**higher breaking load**).

Drilling and eyelets:

Misaligned drilling of the offset, positioned according to the crossing angle of the spokes. Exclusive double eyelets in Al and nickel silver, positioned according to the spokes direction (**perfectly straight spokes, less wear of the spokes, better bedding of the rim**).

Width:

From 20 to 22 mm.

Weight:

The innovating and exclusive Campagnolo technology allows very high performances together with a remarkable reduction of the rims weight.

BREVETTI INTERNAZIONALI



Via della Chimica, 4
36100 VICENZA - Italia

società per azioni
Capitale Sociale Lit. 16.000.000.000
N. 11558 Reg. Soc. Tribunale di Vicenza
Telefono 0444/564933 (16 linee con r.a.)
Telefax 0444/565062
Telex 480074 CAMPA I
Teleg. CAMPAGNOLO VICENZA
Casella Postale N. 822

